

# CHGM-560M/C

5 MP 1/2" CMOS GigE Area Scan Camera



GEN< i >CAM

**GigE**  
VISION

## Introduction

CHGM-560M/C camera adopts GMAX2505 sensor to provide high-quality images. It uses GigE interface to transmit non-compressed images in real time, and its max. frame rate can reach 21 fps in full resolution.

## Key Feature

- Adopts brand new design to reduce power consumption.
- Supports auto or manual adjustment of gain, exposure time, manual adjustment of LUT, Gamma correction, etc.
- Supports customized ROI, horizontal and vertical reverse image output.
- Adopts compact design for flexible installation.
- Compatible with GigE Vision V2.0 Protocol, GenICam Standard, and third-party software based on the protocol and standard.

## Dimension

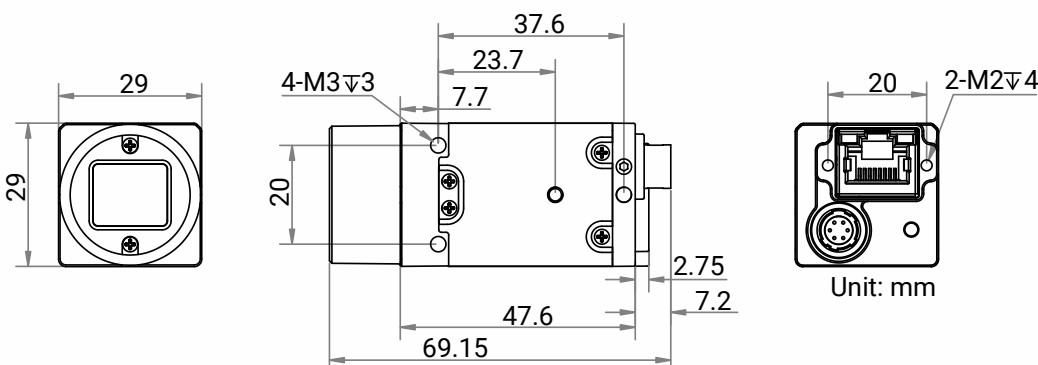

## Available Model

- Mono camera: CHGM-560M
- Color camera: CHGM-560C

## Applicable Industry

Electronic semiconductor, factory automation, liquor and beverage, medicine packing, etc.

## Sensor Quantum Efficiency

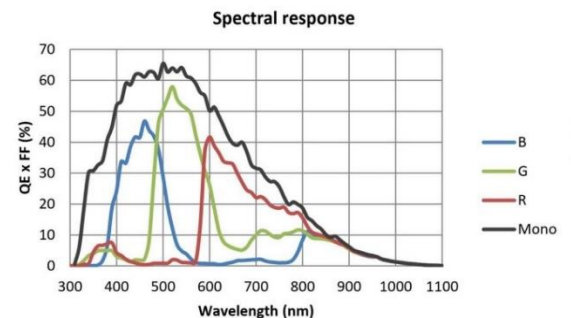

## Specification

Model	CHGM-560M		CHGM-560C
Performance			
Sensor type	CMOS, global shutter		
Sensor model	GMAX2505		
Pixel size	2.5 μm × 2.5 μm		
Sensor size	1/2"		
Resolution	2600 × 2160		
Max. frame rate	21 fps @2600 × 2160 Mono 8	21 fps @2600 × 2160 Bayer BG 8	
Dynamic range	63.8 dB		
SNR	37 dB		
Gain	0 dB to 12 dB		
Exposure time	3 μs to 10 sec		
Exposure mode	Off/Once/Continuous exposure mode		
Mono/color	Mono	Color	
Pixel format	Mono 8/10/10Packed/12/12Packed	Bayer BG 8/10/10Packed/12/12Packed	
Binning	Supports 1 × 1, 2 × 2, 4 × 4		
Decimation	Supports 1 × 1, 2 × 2, 4 × 4		
Reverse image	Supports horizontal and vertical reverse image output		
Electrical features			
Data interface	Gigabit Ethernet, compatible with Fast Ethernet		
Digital I/O	6-pin P7 connector provides power and I/O, including opto-isolated input × 1 (Line 0), opto-isolated output × 1 (Line 1), bi-directional non-isolated I/O × 1 (Line 2).		
Power supply	9 VDC to 24 VDC, PoE is optional		
Power consumption	Typ. 2.3 W@12 VDC	Typ. 2.5 W@12 VDC	
Mechanical			
Lens mount	C-mount		
Dimension	29 mm × 29 mm × 47.6 mm (1.1" × 1.1" × 1.9")		
Weight	Approx. 117 g (0.3 lb.)		
Ingress protection	IP30 (under proper lens installation and wiring)		
Temperature	Working temperature: 0 °C to 50 °C (32 °F to 122 °F) Storage temperature: -30 °C to 70 °C (-22 °F to 158 °F)		
Humidity	20% to 95% RH, non-condensing		
General			
Client software	MVS or third-party software meeting with GigE Vision Protocol		
Operating system	32/64-bit Windows XP/7/10, 32/64-bit Linux and 64-bit MacOS		
Compatibility	GigE Vision V2.0, GenICam		
Certification	CE, RoHS, KC		