

CHUM-500M/C

5 MP 2/3" CMOS USB3.0 Area Scan Camera



GEN*<i>i>*CAM

US3TM
VISION

Introduction

CHUM-500M/C camera adopts Sony® IMX264 sensor to provide high-quality images. It uses USB3.0 interface to transmit non-compressed images in real time, and its max. frame rate can reach 60 fps in full resolution.

Key Feature

- Adopts brand new design to reduce power consumption.
- Supports LSC, Sequencer, Super Palette, etc.
- Supports hardware trigger, software trigger, and free run.
- Compact design with mounting holes on panels for flexible mounting from 4 sides.
- Compatible with USB3 Vision Protocol, GenICam Standard, and the third-party software based on the protocol and standard.

Dimension

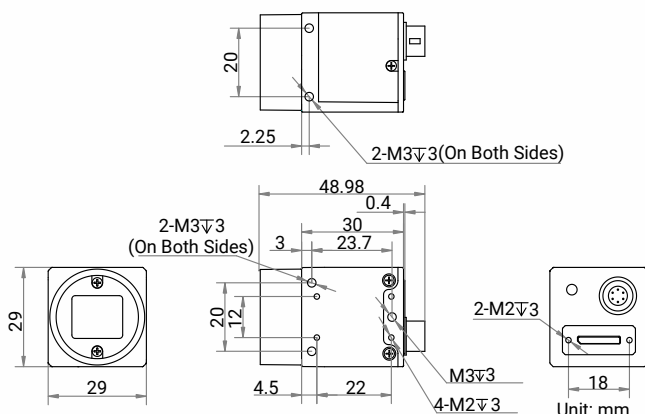

Available Model

- Mono camera: CHUM-500M
- Color camera: CHUM-500C

Applicable Industry

Electronics and semiconductor, factory automation, medicine package, etc.

Sensor Quantum Efficiency

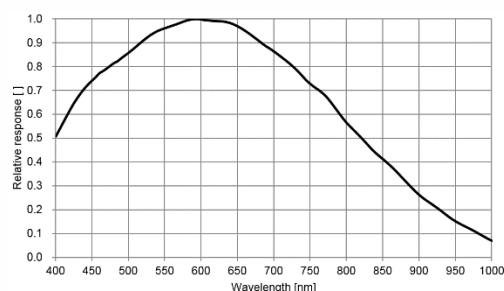

CHUM-500M

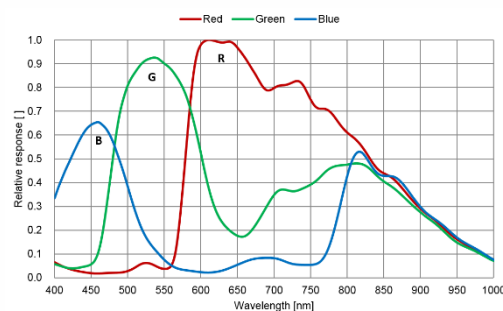

CHUM-500C

Specification

Model	CHUM-500M		CHUM-500C
Performance			
Sensor type	CMOS, global shutter		
Sensor model	Sony® IMX264		
Pixel size	3.45 μm × 3.45 μm		
Sensor size	2/3"		
Resolution	2448 × 2048		
Max. frame rate	60 fps @2448 × 2048 Mono 8	60 fps @2448 × 2048 Bayer RG 8	
Dynamic range	71 dB		
SNR	40 dB		
Gain	0 dB to 24 dB		
Exposure time	UltraShort exposure mode: 1 μs to 14 μs		
	Standard exposure mode: 15 μs to 10 sec		
Exposure mode	Off/Once/Continuous exposure mode		
Mono/color	Mono	Color	
Pixel format	Mono 8/10/10Packed/12/12Packed	Mono 8/10/12, Bayer RG 8/10/10Packed/12/12Packed, YUV422_YUYV_Packed, YUV 422 Packed, RGB 8, BGR 8	
Binning	Supports 1 × 1, 2 × 2, 4 × 4		
Decimation	Supports 1 × 1, 2 × 2		
Reverse image	Supports horizontal and vertical reverse image output		
Electrical features			
Data interface	USB3.0, compatible with USB2.0		
Digital I/O	6-pin P7 connector provides power and I/O, including opto-isolated input × 1 (Line 0), opto-isolated output × 1 (Line 1), bi-directional non-isolated I/O × 1 (Line 2).		
Power supply	9 VDC to 24 VDC, supports USB3.0 power supply		
Power consumption	Typ. 3.2 W@5 VDC (USB3.0 provides power supply)	Typ. 2.8 W@5 VDC (USB3.0 provides power supply)	
Mechanical			
Lens mount	C-Mount		
Dimension	29 mm × 29 mm × 30 mm (1.1" × 1.1" × 1.2")		
Weight	Approx. 80 g (0.2 lb.)		
Ingress protection	IP40 (under proper lens installation and wiring)		
Temperature	Working temperature: -30 °C to 60 °C (-22 °F to 140 °F) Storage temperature: -30 °C to 70 °C (-22 °F to 158 °F)		
Humidity	20% to 95% RH, non-condensing		
General			
Client software	MVS or third-party software meeting with USB3 Vision Protocol		
Operating system	32/64-bit Windows XP/7/10, 32/64-bit Linux and 64-bit MacOS		
Compatibility	USB3 Vision, GenICam		
Certification	CE, KC, RoHS		