

CVL Series 2/3" 1/1.8"

With its large variety of focal lengths, adjustable iris & focus, and support for a wide range of extension tubes and rear converter lenses, the CVL series is a practical match for standard factory automation applications.

- Features**
- 1/2" - 1" sensor support
 - 11 models available
 - Focal length 3.5 - 100mm
 - F1.4 brightness



Table for WD, FOV and Extension Tube Length

Extension Tube (mm)	Model Focal Length	CVL-03514	CVL-04514	CVL-0614	CVL-0813	CVL-1214	CVL-1614	CVL-2514	CVL-3518	CVL-5018	CVL-7527	CVL-10035
		f3.5	f4.5	f6	f8	f12	f16	f25	f35	f50	f75	f100
	Focus	∞~200	∞~200	∞~200	∞~200	∞~300	∞~400	∞~500	∞~300	∞~1000	∞~1000	∞~1000
0	WD	200	200	200	200	300	400	500	300	1000	1000	1000
	1/2"	266.7x355.6	218.2x290.9	165.5x220.7	126.3x168.4	120.0x160.0	120.0x160.0	94.1 x 125.5	41.4x55.2	96.0x128.0	60.0x80.0	48.0x64.0
	1/3"	200.0x266.7	163.6x218.2	124.1x165.5	94.7x126.3	90.0x120.0	90.0x120.0	70.6 x 94.1	31.0x41.4	72.0x96.0	45.0x60.0	36.0x48.0
0.5	Mag.	0.018x	0.022x	0.029x	0.038x	0.040x	0.040x	0.051x	0.116x	0.050x	0.080x	0.100x
	WD			63.0 42.8	118.7 69.4	298.7 143.3	517.2 220.3	1260.9 361.9	2483.1 266.3	4839.7 828.7		
	1/2"			59.3x73.0 43.6x58.2	77.4x103.2 48.0x64.0	120.0x160.0 60.0x80.0	154.8x206.5 67.6x90.1	240.0x320.0 68.6x91.4	342.9x457.1 36.6x48.9	480.0x640.0 78.7x104.9		
1	1/3"			44.4x59.3 32.7x43.6	58.1x77.4 36.0x48.0	90.0x120.0 45.0x60.0	116.1x154.8 50.7x67.6	180.0x240.0 51.4x68.6	257.1x342.9 27.5x36.6	360.0x480.0 59.0x78.7		
	Mag.			0.081x 0.110x	0.062x 0.100x	0.040x 0.080x	0.031x 0.071x	0.020x 0.070x	0.014x 0.131x	0.010x 0.061x		
	WD			53.8 38.3	143.3 91.5	258.0 151.9	631.6 282.0	1199.3 240.7	2326.7 718.0			
1.5	1/2"			38.7x51.6 29.4x39.3	60.0x80.0 40.0x53.3	78.7x104.9 47.5x63.4	120.0x160.0 53.3x71.1	165.5x220.7 33.1x44.1	228.6x304.8 67.6x90.1			
	1/3"			29.0x38.7 22.1x29.4	45.0x60.0 30.0x40.0	59.0x78.7 35.6x47.5	90.0x120.0 40.0x53.3	124.1x165.5 24.8x33.1	171.4x228.6 50.7x67.6			
	Mag.			0.124x 0.163x	0.080x 0.120x	0.061x 0.101x	0.040x 0.090x	0.029x 0.145x	0.021x 0.071x			
2	WD			90.6 65.6	167.7 113.9	421.8 231.2	809.2 219.6	1589.8 634.5	4165.8 820.3			
	1/2"			39.7x52.9 30.0x40.0	52.2x69.6 36.4x48.5	80.0x106.7 43.6x58.2	111.6x148.8 30.2x40.3	154.8x206.5 59.3x79.0	240.0x320.0 46.2x61.5			
	1/3"			29.8x39.7 22.5x30.0	39.1x52.2 27.3x36.4	60.0x80.0 32.7x43.6	83.7x111.6 22.6x30.2	116.1x154.8 44.4x59.3	180.0x240.0 34.6x46.2			
5	Mag.			0.121x 0.160x	0.092x 0.132x	0.060x 0.110x	0.043x 0.159x	0.031x 0.081x	0.020x 0.104x			
	WD			65.1 49.7	124.1 91.0	321.0 196.0	600.2 200.7	1184.5 563.7	3185.4 777.0	5016.3 845.5		
	1/2"			29.8x39.8 23.9x31.8	39.3x52.5 29.6x39.5	60.8x81.0 36.9x49.2	82.8x110.3 27.6x36.8	114.3x152.4 52.2x69.6	184.6x246.2 42.9x57.1	228.6x304.8 37.2x49.6		
10	1/3"			22.4x29.8 17.9x23.9	29.5x39.3 22.2x29.6	45.6x60.8 27.7x36.9	62.1x82.8 20.7x27.6	85.7x114.3 39.1x52.2	138.5x184.6 32.1x42.9	171.4x228.6 27.9x37.2		
	Mag.			0.161x 0.201x	0.122x 0.162x	0.079x 0.130x	0.058x 0.174x	0.042x 0.092x	0.026x 0.112x	0.021x 0.129x		
	WD			43.5 37.4	128.8 103.4	242.3 134.7	503.6 103.4	923.6 142.5	1420.5 607.8	2268.1 712.1		
15	1/2"			15.7x20.9 13.9x18.5	24.1x32.2 19.3x25.7	33.3x44.4 18.5x24.6	46.2x61.5 31.2x41.6	73.8x98.5 30.2x40.3	92.3x123.1 27.6x36.8			
	1/3"			11.8x15.7 10.4x13.9	18.1x24.1 14.5x19.3	25.0x33.3 13.8x18.5	34.6x46.2 23.4x31.2	55.4x73.8 22.6x30.2	69.2x92.3 20.7x27.6			
	Mag.			0.306x 0.346x	0.199x 0.249x	0.144x 0.260x	0.104x 0.154x	0.065x 0.159x	0.052x 0.174x			
20	WD			65.7 58.5	121.7 87.0	272.9 227.5	832.2 475.4	1352.1 595.7				
	1/2"			12.1x16.1 10.7x14.3	16.7x22.2 11.9x15.8	23.1x30.8 18.5x24.7	36.9x49.2 20.2x26.9	46.2x61.5 19.4x25.9				
	1/3"			9.1x12.1 8.0x10.7	12.5x16.7 8.9x11.9	17.3x23.1 13.9x18.5	27.7x36.9 15.1x20.2	34.6x46.2 14.6x19.4				
25	Mag.			0.397x 0.448x	0.288x 0.404x	0.208x 0.259x	0.130x 0.238x	0.104x 0.247x				
	WD			44.6 41.2	81.5 64.4	195.5 174.4	636.1 409.0	1046.8 532.7				
	1/2"			8.1x10.7 7.4x9.9	11.1x14.8 8.8x11.7	15.3x20.4 13.2x17.6	24.5x32.7 15.1x20.2	30.6x40.8 15.0x19.9				
30	1/3"			6.0x8.1 5.6x7.4	8.3x11.1 6.6x8.8	11.5x15.3 9.9x13.2	18.4x24.5 11.4x15.1	22.9x30.6 11.2x15.0				
	Mag.			0.596x 0.647x	0.432x 0.548x	0.313x 0.363x	0.196x 0.317x	0.157x 0.321x				
	WD			34.0 32.1	61.4 51.2	157.3 145.0	538.1 369.1	894.1 493.3				
35	1/2"			6.0x8.1 5.7x7.6	8.3x11.1 6.9x9.2	11.5x15.3 10.3x13.7	18.4x24.5 12.1x16.2	23.0x30.6 12.2x16.2				
	1/3"			4.5x6.0 4.3x5.7	6.3x8.3 5.2x6.9	8.6x11.5 7.7x10.3	13.8x18.4 9.1x12.1	17.2x23.0 9.1x12.2				
	Mag.			0.795x 0.845x	0.576x 0.692x	0.417x 0.467x	0.261x 0.396x	0.209x 0.395x				
40	WD			49.4 42.6	134.3 126.3	479.2 342.5	802.5 466.3					
	1/2"			6.7x8.9 5.7x7.7	9.2x12.3 8.4x11.2	14.7x19.6 10.1x13.5	18.4x24.5 10.3x13.7					
	1/3"			5.0x6.7 4.3x5.7	6.9x9.2 6.3x8.4	11.0x14.7 7.6x10.1	13.8x18.4 7.7x10.3					
45	Mag.			0.719x 0.836x	0.521x 0.571x	0.326x 0.474x	0.261x 0.468x					
	WD			41.3 36.5	119.0 113.3	440.0 323.4	741.4 446.6					
	1/2"			5.6x7.4 4.9x6.5	7.7x10.2 7.1x9.5	12.3x16.4 8.7x11.6	15.3x20.4 8.9x11.8					
50	1/3"			4.2x5.6 3.7x4.9	5.8x7.7 5.3x7.1	9.2x12.3 6.5x8.7	11.5x15.3 6.8x8.9					
	Mag.			0.863x 0.980x	0.625x 0.675x	0.391x 0.553x	0.313x 0.542x					
	WD			35.5 32.0	108.0 103.8	412.0 309.1	697.8 431.6					
55	1/2"			4.8x6.4 4.3x5.7	6.6x8.8 6.2x8.2	10.5x14.0 7.6x10.1	13.1x17.5 7.8x10.4					
	1/3"			3.6x4.8 3.2x4.3	4.9x6.6 4.6x6.2	7.9x10.5 5.7x7.6	9.8x13.1 5.8x7.8					
	Mag.			1.007x 1.123x	0.730x 0.780x	0.456x 0.632x	0.366x 0.616x					
60	WD			99.8 96.5	391.0 298.0	665.1 419.8						
	1/2"			5.8x7.7 5.4x7.2	9.2x12.3 6.8x9.0	11.5x15.3 7.0x9.3						
	1/3"			4.3x5.8 4.1x5.4	6.9x9.2 5.1x6.8	8.6x11.5 5.2x7.0						
65	Mag.			0.834x 0.884x	0.522x 0.711x	0.418x 0.690x						
	WD			93.4 90.8	374.7 289.1	639.6 410.3						
	1/2"			5.1x6.8 4.9x6.5	8.2x10.9 6.1x8.1	10.2x13.6 6.3x8.4						
70	1/3"			3.8x5.1 3.6x4.9	6.1x8.2 4.6x6.1	7.7x10.2 4.7x6.3						
	Mag.			0.938x 0.988x	0.587x 0.790x	0.470x 0.763x						
	WD			88.3 86.2	361.6 281.8	619.3 402.5						
75	1/2"			4.6x6.1 4.4x5.9	7.4x9.8 5.5x7.4	9.2x12.3 5.7x7.6						
	1/3"			3.5x4.6 3.3x4.4	5.5x7.4 4.1x5.5	6.9x9.2 4.3x5.7						
	Mag.			1.042x 1.092x	0.652x 0.869x	0.522x 0.837x						

Description of the table above

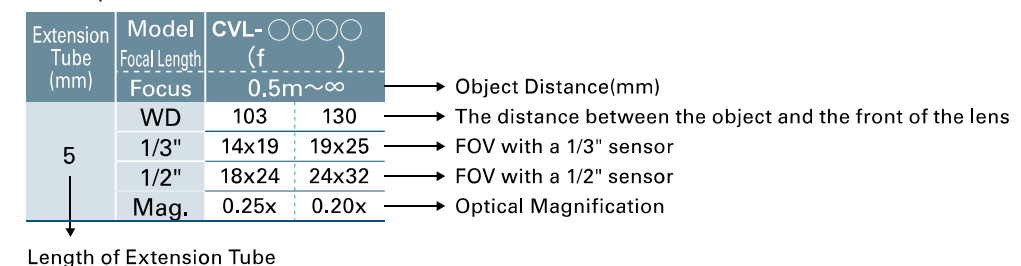

CVL-03514

*Filter adapter, SV-FAD28-305, is available. (P143)

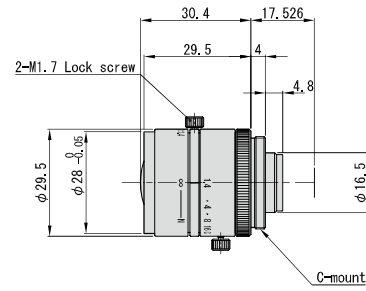

Focal Length (f)	3.5 mm
Maximum Aperture Ratio	1:1.4
Aperture	F1.4 ~ Close
Angle of View (1/2°)	77.8° x 105.9°
M.O.D	200 mm
TV Distortion (1/2°)	-14.65 %
Operation	Manual(Lock screw M1.7)
Wavelength	Visible
Mount	C-Mount
Flange Back	17.526 mm
Sensor Size (max.)	1/2"
Weight (approx.)	52 g
Dimension	φ29.5(max.) x L = 30.4 mm

CVL-04514

*Filter adapter, SV-FAD28-305, is available. (P143)

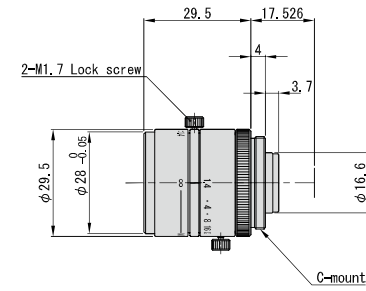

Focal Length (f)	4.5 mm
Maximum Aperture Ratio	1:1.4
Aperture	F1.4 ~ Close
Angle of View (1/2°)	59.7° x 79.9°
M.O.D	200 mm
TV Distortion (1/2°)	-8.15 %
Operation	Manual(Lock screw M1.7)
Wavelength	Visible
Mount	C-Mount
Flange Back	17.526 mm
Sensor Size (max.)	1/2"
Weight (approx.)	54 g
Dimension	φ29.5(max.) x L = 29.5 mm

CVL-0614

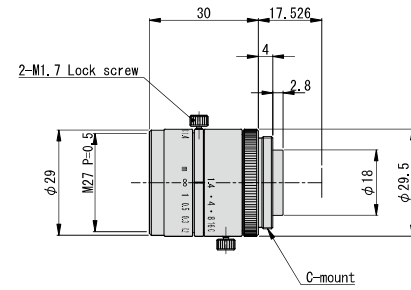

Focal Length (f)	6 mm
Maximum Aperture Ratio	1:1.4
Aperture	F1.4 ~ Close
Angle of View (1/2°)	43.4° x 56.6°
M.O.D	200 mm
TV Distortion (1/2°)	-1.36 %
Operation	Manual(Lock screw M1.7)
Wavelength	Visible
Mount	C-Mount
Flange Back	17.526 mm
Sensor Size (max.)	1/2"
Filter Thread	M 27 P = 0.5
Weight (approx.)	47 g
Dimension	φ29.5(max.) x L = 30 mm

CVL-0813

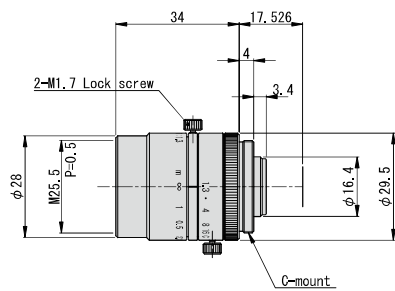

Focal Length (f)	8 mm
Maximum Aperture Ratio	1:1.3
Aperture	F1.3 ~ Close
Angle of View (2/3°)	49.0° x 57.2°
M.O.D	200 mm
TV Distortion (2/3°)	-1.57 %
Operation	Manual(Lock screw M1.7)
Wavelength	Visible
Mount	C-Mount
Flange Back	17.526 mm
Sensor Size (max.)	2/3"
Filter Thread	M 25.5 P = 0.5
Weight (approx.)	54 g
Dimension	φ29.5(max.) x L = 34 mm

CVL-1214

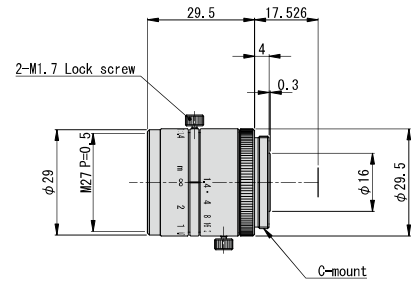

Focal Length (f)	12 mm
Maximum Aperture Ratio	1:1.4
Aperture	F1.4 ~ Close
Angle of View (1/2°)	21.9° x 29.1°
M.O.D	300 mm
TV Distortion (1/2°)	-0.31 %
Operation	Manual(Lock screw M1.7)
Wavelength	Visible
Mount	C-Mount
Flange Back	17.526 mm
Sensor Size (max.)	1/2"
Filter Thread	M 27 P = 0.5
Weight (approx.)	43 g
Dimension	φ29.5(max.) x L = 29.5 mm

CVL-1614

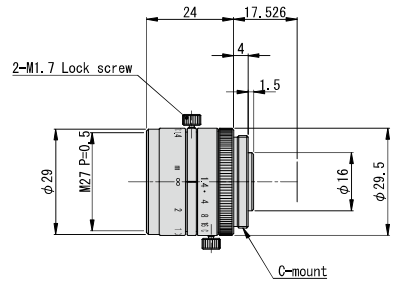

Focal Length (f)	16 mm
Maximum Aperture Ratio	1:1.4
Aperture	F1.4 ~ Close
Angle of View (2/3°)	24.6° x 28.9°
M.O.D	400 mm
TV Distortion (2/3°)	-0.08 %
Operation	Manual(Lock screw M1.7)
Wavelength	Visible
Mount	C-Mount
Flange Back	17.526 mm
Sensor Size (max.)	2/3"
Filter Thread	M 27 P = 0.5
Weight (approx.)	34 g
Dimension	φ29.5(max.) x L = 24 mm

CVL-2414

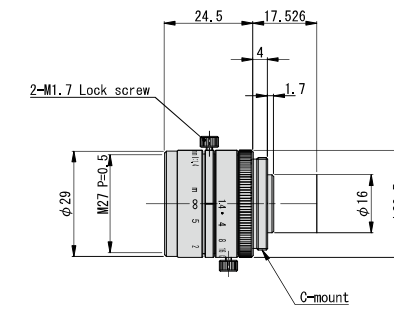

Focal Length (f)	25 mm
Maximum Aperture Ratio	1:1.4
Aperture	F1.4 ~ Close
Angle of View (2/3°)	16.1° x 19.0°
M.O.D	500 mm
TV Distortion (2/3°)	-0.33 %
Operation	Manual(Lock screw M1.7)
Wavelength	Visible
Mount	C-Mount
Flange Back	17.526 mm
Sensor Size (max.)	1"
Filter Thread	M 27 P = 0.5
Weight (approx.)	36 g
Dimension	φ29.5(max.) x L = 24.5 mm

CVL-3518

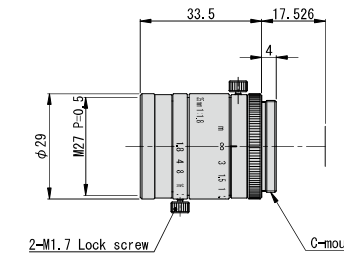

Focal Length (f)	35 mm
Maximum Aperture Ratio	1:1.8
Aperture	F1.8 ~ Close
Angle of View (2/3°)	11.7° x 13.8°
M.O.D	300 mm
TV Distortion (2/3°)	-0.12 %
Operation	Manual(Lock screw M1.7)
Wavelength	Visible
Mount	C-Mount
Flange Back	17.526 mm
Sensor Size (max.)	2/3"
Filter Thread	M 27 P = 0.5
Weight (approx.)	48 g
Dimension	φ29(max.) x L = 33.5 mm

CVL-0518

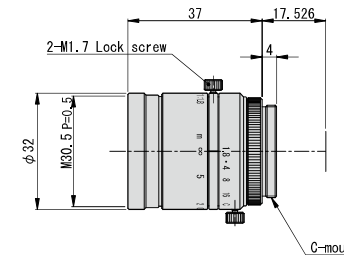

Focal Length (f)	50 mm
Maximum Aperture Ratio	1:1.8
Aperture	F1.8 ~ Close
Angle of View (2/3°)	8.5° x 10.0°
M.O.D	1000 mm
TV Distortion (2/3°)	0.10 %
Operation	Manual(Lock screw M1.7)
Wavelength	Visible
Mount	C-Mount
Flange Back	17.526 mm
Sensor Size (max.)	2/3"
Filter Thread	M 30.5 P = 0.5
Weight (approx.)	66g
Dimension	φ32(max.) x L = 37 mm

CVL-7527

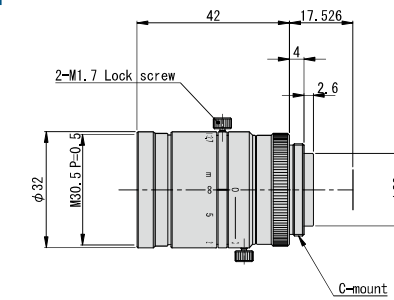

Focal Length (f)	75 mm
Maximum Aperture Ratio	1:2.7
Aperture	F2.7 ~ Close
Angle of View (1/2°)	3.6° x 4.7°
M.O.D	1000 mm
TV Distortion (1/2°)	0.55 %
Operation	Manual(Lock screw M1.7)
Wavelength	Visible
Mount	C-Mount
Flange Back	17.526 mm
Sensor Size (max.)	1/2"
Filter Thread	M 30.5 P = 0.5
Weight (approx.)	74g
Dimension	φ32(max.) x L = 42 mm

CVL-10035

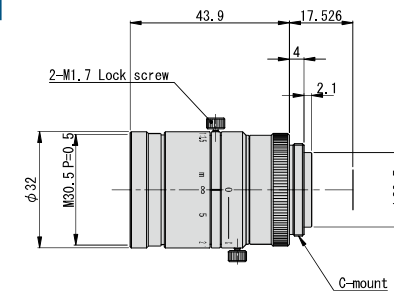

Focal Length (f)	100 mm
Maximum Aperture Ratio	1:3.5
Aperture	F3.5 ~ Close
Angle of View (1/2°)	2.9° x 3.8°
M.O.D	1000 mm
TV Distortion (1/2°)	0.56 %
Operation	Manual(Lock screw M1.7)
Wavelength	Visible
Mount	C-Mount
Flange Back	17.526 mm
Sensor Size (max.)	1/2"
Filter Thread	M 30.5 P = 0.5
Weight (approx.)	76g
Dimension	φ32(max.) x L = 43.9 mm

CVL Series 1/1.8"

When designing this series we wanted to deliver the best image possible with a fixed focal length lens, while keeping the lens compact. This CVL series has an uncompromisingly excellent resolution and high contrast, making it the best choice for any machine vision application using a camera, with up to a 1/1.8" sensor.

Features

- 1/1.8" sensor support
- 7 models available
- Focal length 6 - 50mm
- Vibration resistant design
- High contrast & resolution
- F1.8 brightness
- Compact design



Table for WD, FOV and Extension Tube Length

Extension Tube (mm)	Model Focal Length	CVL-0620	CVL-0818	CVL-1218	CVL-1618	CVL-2518	CVL-3518	CVL-5026	
		f6	F8	f12	f16	f25	f35	f50	
Focus		∞ ~ 100		∞ ~ 100		∞ ~ 250		∞ ~ 400	
0	WD	100	100	100	100	250	250	400	
	1/1.8"	98.2x129.1	75.0x98.6	50.9x67.0	36.0x47.3	55.7x73.2	38.6x50.7	39.4x51.8	
	1/2"	87.3x116.4	66.7x88.9	45.3x60.4	32.0x42.7	49.5x66.0	34.3x45.7	35.0x46.7	
0.5	Mag.	0.055x	0.072x	0.106x	0.150x	0.097x	0.140x	0.137x	
	WD	63.5	32.7	119.7	47.1	283.0	68.1	518.0	81.6
	1/1.8"	66.7x87.7	39.7x52.2	88.5x116.4	40.6x53.4	131.7x173.2	36.7x48.3	174.2x229.0	30.0x39.4
1	1/2"	59.3x79.0	35.3x47.1	78.7x104.9	36.1x48.1	117.1x156.1	32.7x43.5	154.8x206.5	26.7x35.6
	Mag.	0.081x	0.136x	0.061x	0.133x	0.041x	0.147x	0.031x	0.180x
	WD	63.5	32.7	119.7	47.1	283.0	68.1	518.0	81.6
1.5	1/1.8"	66.7x87.7	39.7x52.2	88.5x116.4	40.6x53.4	131.7x173.2	36.7x48.3	174.2x229.0	30.0x39.4
	1/2"	59.3x79.0	35.3x47.1	78.7x104.9	36.1x48.1	117.1x156.1	32.7x43.5	154.8x206.5	26.7x35.6
	Mag.	0.081x	0.136x	0.061x	0.133x	0.041x	0.147x	0.031x	0.180x
2	WD	63.5	32.7	119.7	47.1	283.0	68.1	518.0	81.6
	1/1.8"	66.7x87.7	39.7x52.2	88.5x116.4	40.6x53.4	131.7x173.2	36.7x48.3	174.2x229.0	30.0x39.4
	1/2"	59.3x79.0	35.3x47.1	78.7x104.9	36.1x48.1	117.1x156.1	32.7x43.5	154.8x206.5	26.7x35.6
5	Mag.	0.081x	0.136x	0.061x	0.133x	0.041x	0.147x	0.031x	0.180x
	WD	63.5	32.7	119.7	47.1	283.0	68.1	518.0	81.6
	1/1.8"	66.7x87.7	39.7x52.2	88.5x116.4	40.6x53.4	131.7x173.2	36.7x48.3	174.2x229.0	30.0x39.4
10	1/2"	59.3x79.0	35.3x47.1	78.7x104.9	36.1x48.1	117.1x156.1	32.7x43.5	154.8x206.5	26.7x35.6
	Mag.	0.081x	0.136x	0.061x	0.133x	0.041x	0.147x	0.031x	0.180x
	WD	63.5	32.7	119.7	47.1	283.0	68.1	518.0	81.6
15	1/1.8"	66.7x87.7	39.7x52.2	88.5x116.4	40.6x53.4	131.7x173.2	36.7x48.3	174.2x229.0	30.0x39.4
	1/2"	59.3x79.0	35.3x47.1	78.7x104.9	36.1x48.1	117.1x156.1	32.7x43.5	154.8x206.5	26.7x35.6
	Mag.	0.081x	0.136x	0.061x	0.133x	0.041x	0.147x	0.031x	0.180x
20	WD	63.5	32.7	119.7	47.1	283.0	68.1	518.0	81.6
	1/1.8"	66.7x87.7	39.7x52.2	88.5x116.4	40.6x53.4	131.7x173.2	36.7x48.3	174.2x229.0	30.0x39.4
	1/2"	59.3x79.0	35.3x47.1	78.7x104.9	36.1x48.1	117.1x156.1	32.7x43.5	154.8x206.5	26.7x35.6
25	Mag.	0.081x	0.136x	0.061x	0.133x	0.041x	0.147x	0.031x	0.180x
	WD	63.5	32.7	119.7	47.1	283.0	68.1	518.0	81.6
	1/1.8"	66.7x87.7	39.7x52.2	88.5x116.4	40.6x53.4	131.7x173.2	36.7x48.3	174.2x229.0	30.0x39.4
30	1/2"	59.3x79.0	35.3x47.1	78.7x104.9	36.1x48.1	117.1x156.1	32.7x43.5	154.8x206.5	26.7x35.6
	Mag.	0.081x	0.136x	0.061x	0.133x	0.041x	0.147x	0.031x	0.180x
	WD	63.5	32.7	119.7	47.1	283.0	68.1	518.0	81.6
35	1/1.8"	66.7x87.7	39.7x52.2	88.5x116.4	40.6x53.4	131.7x173.2	36.7x48.3	174.2x229.0	30.0x39.4
	1/2"	59.3x79.0	35.3x47.1	78.7x104.9	36.1x48.1	117.1x156.1	32.7x43.5	154.8x206.5	26.7x35.6
	Mag.	0.081x	0.136x	0.061x	0.133x	0.041x	0.147x	0.031x	0.180x
40	WD	63.5	32.7	119.7	47.1	283.0	68.1	518.0	81.6
	1/1.8"	66.7x87.7	39.7x52.2	88.5x116.4	40.6x53.4	131.7x173.2	36.7x48.3	174.2x229.0	30.0x39.4
	1/2"	59.3x79.0	35.3x47.1	78.7x104.9	36.1x48.1	117.1x156.1	32.7x43.5	154.8x206.5	26.7x35.6
45	Mag.	0.081x	0.136x	0.061x	0.133x	0.041x	0.147x	0.031x	0.180x
	WD	63.5	32.7	119.7	47.1	283.0	68.1	518.0	81.6
	1/1.8"	66.7x87.7	39.7x52.2	88.5x116.4	40.6x53.4	131.7x173.2	36.7x48.3	174.2x229.0	30.0x39.4
50	1/2"	59.3x79.0	35.3x47.1	78.7x104.9	36.1x48.1	117.1x156.1	32.7x43.5	154.8x206.5	26.7x35.6
	Mag.	0.081x	0.136x	0.061x	0.133x	0.041x	0.147x	0.031x	0.180x
	WD	63.5	32.7	119.7	47.1	283.0	68.1	518.0	81.6

Description of the table above

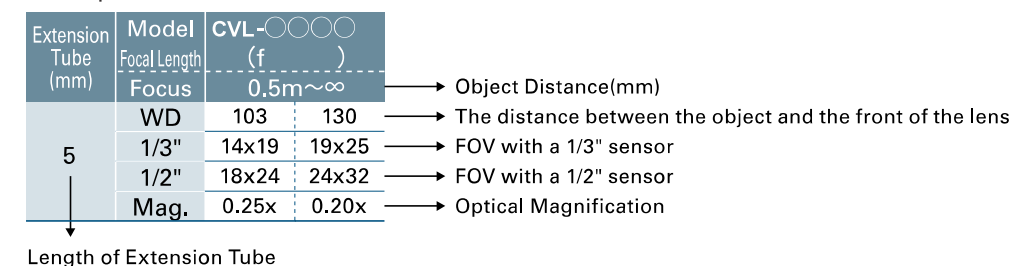

CVL-0620

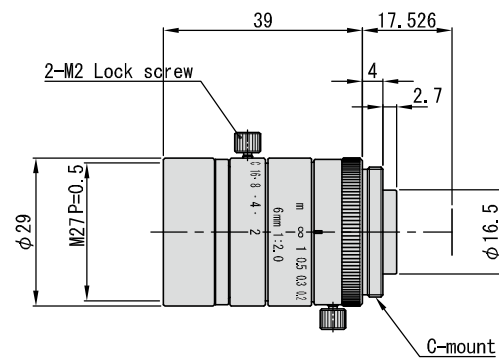

Focal Length (f)	6 mm
Maximum Aperture Ratio	1:2.0
Aperture	F2 ~ Close
Angle of View (1/1.8")	48.4° x 61.9°
M.O.D	100 mm
TV Distortion (1/1.8")	-1.42 %
Operation of Iris & Focus	Manual(Lock screw M2)
Wavelength	Visible
Mount	C-Mount
Flange Back	17526 mm
Sensor Size (max.)	1/1.8"
Filter Thread	M 27 P = 0.5
Weight (approx.)	62 g
Dimension	φ29(max.) x L = 39 mm

CVL-2518

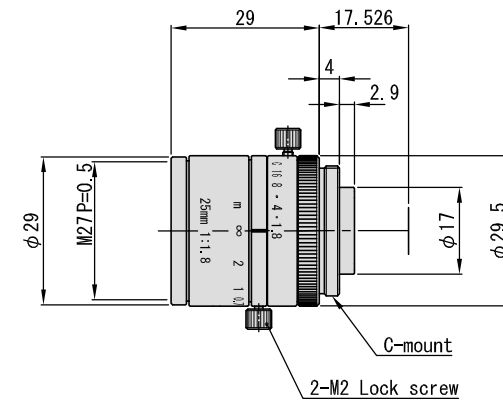

Focal Length (f)	25 mm
Maximum Aperture Ratio	1:1.8
Aperture	F1.8 ~ Close
Angle of View (1/1.8")	12.1° x 15.9°
M.O.D	250 mm
TV Distortion (1/1.8")	-0.15 %
Operation of Iris & Focus	Manual(Lock screw M2)
Wavelength	Visible
Mount	C-Mount
Flange Back	17526 mm
Sensor Size (max.)	1/1.8"
Filter Thread	M 27 P = 0.5
Weight (approx.)	60 g
Dimension	φ29.5(max.) x L = 29 mm

CVL-0818

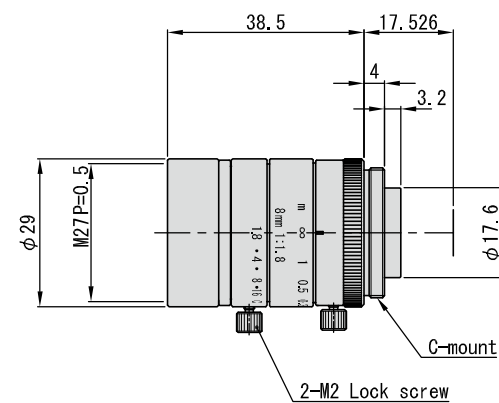

Focal Length (f)	8 mm
Maximum Aperture Ratio	1:1.8
Aperture	F1.8 ~ Close
Angle of View (1/1.8")	37.2° x 48.2°
M.O.D	100 mm
TV Distortion (1/1.8")	-1.19 %
Operation of Iris & Focus	Manual(Lock screw M2)
Wavelength	Visible
Mount	C-Mount
Flange Back	17526 mm
Sensor Size (max.)	1/1.8"
Filter Thread	M 27 P = 0.5
Weight (approx.)	64 g
Dimension	φ29(max.) x L = 38.5 mm

CVL-3518

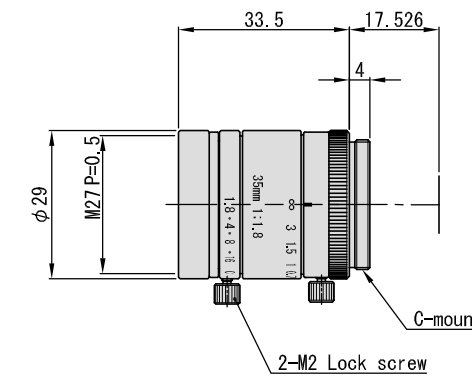

Focal Length (f)	35 mm
Maximum Aperture Ratio	1:1.8
Aperture	F1.8 ~ Close
Angle of View (2/3")	11.7° x 13.8°
M.O.D	250 mm
TV Distortion (2/3")	-0.12 %
Operation of Iris & Focus	Manual(Lock screw M2)
Wavelength	Visible
Mount	C-Mount
Flange Back	17526 mm
Sensor Size (max.)	2/3"
Filter Thread	M 27 P = 0.5
Weight (approx.)	48 g
Dimension	φ29(max.) x L = 33.5 mm

CVL-1218

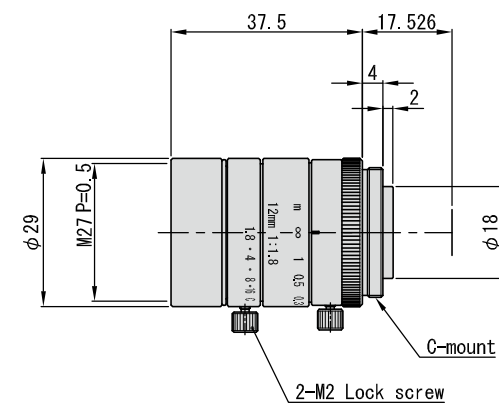

Focal Length (f)	12 mm
Maximum Aperture Ratio	1:1.8
Aperture	F1.8 ~ Close
Angle of View (1/1.8")	25° x 32.6°
M.O.D	100 mm
TV Distortion (1/1.8")	-0.19 %
Operation of Iris & Focus	Manual(Lock screw M2)
Wavelength	Visible
Mount	C-Mount
Flange Back	17526 mm
Sensor Size (max.)	1/1.8"
Filter Thread	M 27 P = 0.5
Weight (approx.)	60 g
Dimension	φ29(max.) x L = 37.5 mm

CVL-5026

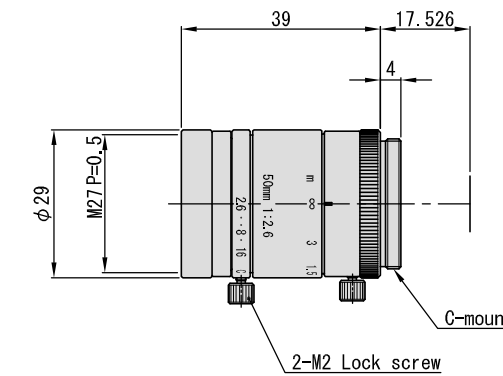

Focal Length (f)	50 mm
Maximum Aperture Ratio	1:2.6
Aperture	F2.6 ~ Close
Angle of View (2/3")	8.1° x 9.6°
M.O.D	400 mm
TV Distortion (2/3")	0.01 %
Operation of Iris & Focus	Manual(Lock screw M2)
Wavelength	Visible
Mount	C-Mount
Flange Back	17526 mm
Sensor Size (max.)	2/3"
Filter Thread	M 27 P = 0.5
Weight (approx.)	54 g
Dimension	φ29(max.) x L = 39 mm

CVL-1618

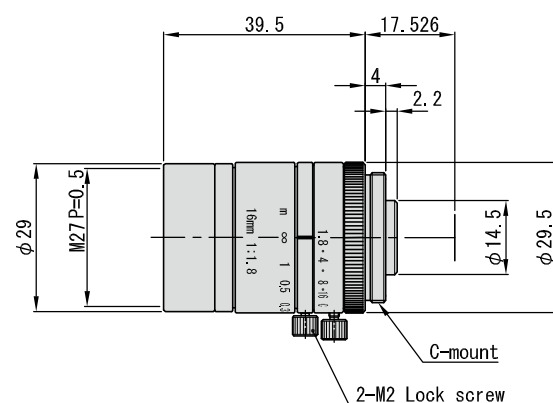

Focal Length (f)	16 mm
Maximum Aperture Ratio	1:1.8
Aperture	F1.8 ~ Close
Angle of View (1/1.8")	18.8° x 24.6°
M.O.D	100 mm
TV Distortion (1/1.8")	-0.14 %
Operation of Iris & Focus	Manual(Lock screw M2)
Wavelength	Visible
Mount	C-Mount
Flange Back	17526 mm
Sensor Size (max.)	1/1.8"
Filter Thread	M 27 P = 0.5
Weight (approx.)	58 g
Dimension	φ29.5(max.) x L = 39.5 mm

CVL-M Series 2/3" 1/1.8"

The CVL-M series' focus of delivering a high resolution, makes it an excellent choice for cameras that utilize up to 2/3" sensors. The bright F number helps illuminate the view even in a poorly lit environment. Designed to suit a large range of working distances, the iris and focus are adjustable, making this series well prepared for almost any application.

- Features**
- 2/3" sensor support
 - 13 models available
 - Focal length 6 - 100mm
 - F1.4 brightness
 - High Resolution
 - All models filter-ready



Table for WD, FOV and Extension Tube Length

Extension Tube (mm)	Model Focal Length	CVL-0614M	CVL-0814M	CVL-1214M	CVL-1614M	CVL-2514M	CVL-3514M	CVL-5014M	CVL-5026M	CVL-7525M	CVL-10028M
		f6	f8	f12	f16	f25	f35	f50	f50	f75	f100
	Focus	∞~100	∞~100	∞~100	∞~100	∞~150	∞~200	∞~300	∞~500	∞~1200	∞~2000
0	WD	100	100	100	100	150	200	300	500	1200	2000
	2/3"	134.0x158.5	101.4x120.0	68.9x81.6	52.2x61.8	47.7x56.4	42.0x49.7	42.3x50.0	65.7x77.8	102.9x121.7	136.5x161.5
	1/2"	90.6x120.8	68.6x91.4	46.6x62.1	35.3x47.1	32.2x43.0	28.4x37.9	28.6x38.1	44.4x59.3	69.6x92.8	92.3x123.1
	Mag.	0.053x	0.070x	0.103x	0.136x	0.149x	0.169x	0.168x	0.108x	0.069x	0.052x

Description of the table above

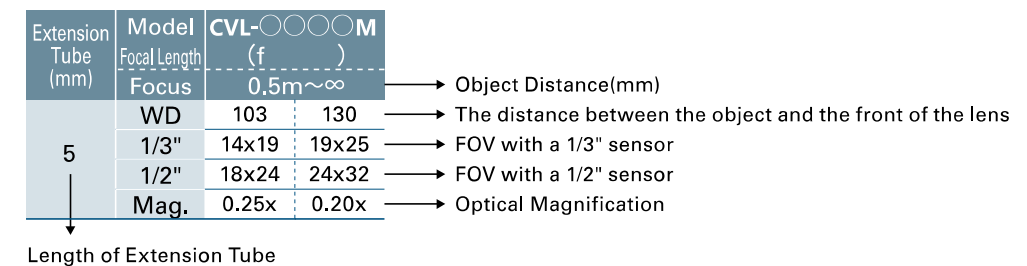

CVL-0614M

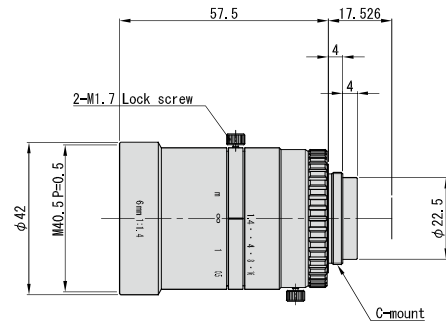

Focal Length (f)	6 mm
Maximum Aperture Ratio	1:1.4
Aperture	F1.4 ~ 16
Angle of View (2/3")	60.3° x 69.0°
M.O.D	100 mm
TV Distortion (2/3")	-0.06 %
Operation	Manual(Lock screw M1.7)
Wavelength	Visible
Mount	C-Mount
Flange Back	17.526 mm
Sensor Size (max.)	2/3"
Filter Thread	M 40.5 P = 0.5
Weight (approx.)	142 g
Dimension	φ42(max.) x L = 57.5 mm

CVL-0814M

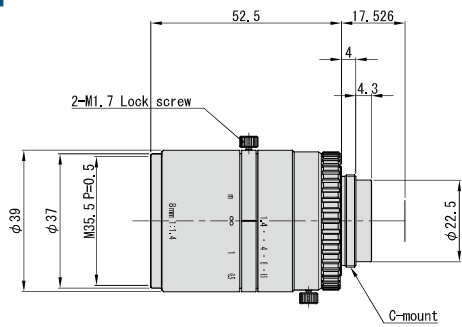

Focal Length (f)	8 mm
Maximum Aperture Ratio	1:1.4
Aperture	F1.4 ~ 16
Angle of View (2/3")	47.9° x 55.4°
M.O.D	100 mm
TV Distortion (2/3")	0.10 %
Operation	Manual(Lock screw M1.7)
Wavelength	Visible
Mount	C-Mount
Flange Back	17.526 mm
Sensor Size (max.)	2/3"
Filter Thread	M 35.5 P = 0.5
Weight (approx.)	124 g
Dimension	φ39(max.) x L = 52.5 mm

CVL-1214MF

Floating System

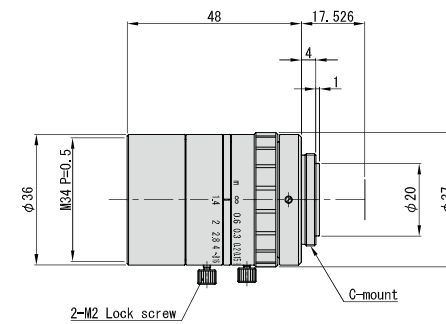

Focal Length (f)	12 mm
Maximum Aperture Ratio	1:1.4
Aperture	F1.4 ~ 16
Angle of View (2/3")	33.4° x 39.1°
M.O.D	100 mm
TV Distortion (2/3")	0.04 %
Operation	Manual(Lock screw M1.7)
Wavelength	Visible
Mount	C-Mount
Flange Back	17.526 mm
Sensor Size (max.)	2/3"
Filter Thread	M 34 P = 0.5
Weight (approx.)	112 g
Dimension	φ37(max.) x L = 48 mm

CVL-1614MF

Floating System

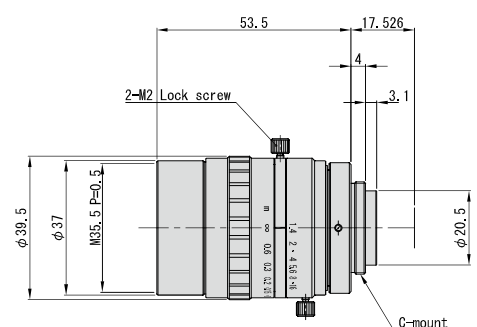

Focal Length (f)	16 mm
Maximum Aperture Ratio	1:1.4
Aperture	F1.4 ~ 16
Angle of View (2/3")	24.5° x 28.9°
M.O.D	100 mm
TV Distortion (2/3")	-0.18 %
Operation	Manual(Lock screw M1.7)
Wavelength	Visible
Mount	C-Mount
Flange Back	17.526 mm
Sensor Size (max.)	2/3"
Filter Thread	M 35.5 P = 0.5
Weight (approx.)	124 g
Dimension	φ39.5(max.) x L = 53.5 mm

CVL-2514M

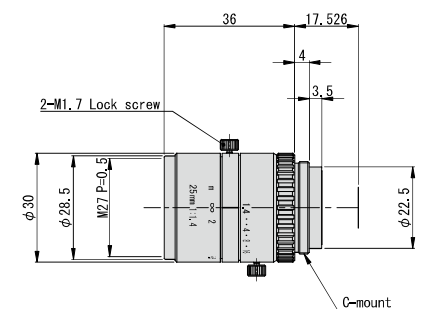

Focal Length (f)	25 mm
Maximum Aperture Ratio	1:1.4
Aperture	F1.4 ~ 16
Angle of View (2/3")	16.2° x 19.1°
M.O.D	150 mm
TV Distortion (2/3")	-0.06 %
Operation	Manual(Lock screw M1.7)
Wavelength	Visible
Mount	C-Mount
Flange Back	17.526 mm
Sensor Size (max.)	2/3"
Filter Thread	M 27 P = 0.5
Weight (approx.)	60 g
Dimension	φ30(max.) x L = 36 mm

CVL-3514M

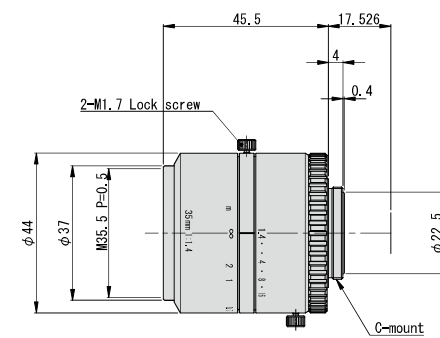

Focal Length (f)	35 mm
Maximum Aperture Ratio	1:1.4
Aperture	F1.4 ~ 16
Angle of View (2/3")	11.6° x 13.7°
M.O.D	200 mm
TV Distortion (2/3")	-0.13 %
Operation	Manual(Lock screw M1.7)
Wavelength	Visible
Mount	C-Mount
Flange Back	17.526 mm
Sensor Size (max.)	2/3"
Filter Thread	M 35.5 P = 0.5
Weight (approx.)	142 g
Dimension	φ44(max.) x L = 45.5 mm

CVL-5014M

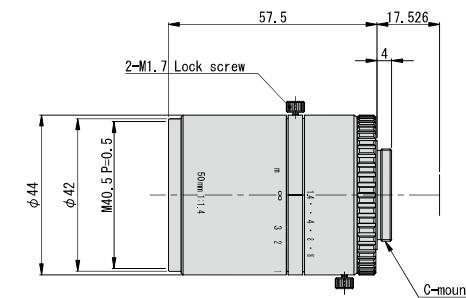

Focal Length (f)	50 mm
Maximum Aperture Ratio	1:1.4
Aperture	F1.4 ~ 16
Angle of View (2/3")	8.1° x 9.6°
M.O.D	300 mm
TV Distortion (2/3")	0.02 %
Operation	Manual(Lock screw M1.7)
Wavelength	Visible
Mount	C-Mount
Flange Back	17.526 mm
Sensor Size (max.)	2/3"
Filter Thread	M 40.5 P = 0.5
Weight (approx.)	165 g
Dimension	φ44(max.) x L = 57.5 mm

CVL-7525M

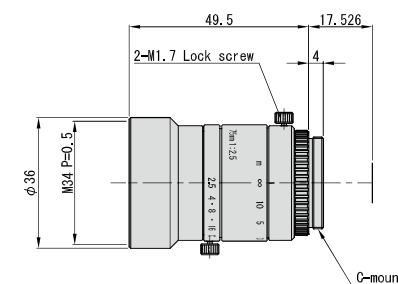

Focal Length (f)	75 mm
Maximum Aperture Ratio	1:2.5
Aperture	F2.5 ~ Close
Angle of View (1")	8.6° x 8.6°
M.O.D	1200 mm
TV Distortion (1")	0.05 %
Operation	Manual(Lock screw M1.7)
Wavelength	Visible
Mount	C-Mount
Flange Back	17.526 mm
Sensor Size (max.)	1"
Filter Thread	M 34 P = 0.5
Weight (approx.)	84 g
Dimension	φ36(max.) x L = 49.5 mm

CVL-10028M

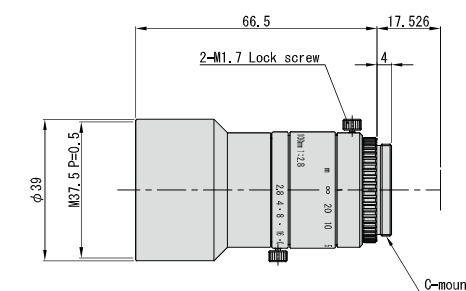

Focal Length (f)	100 mm
Maximum Aperture Ratio	1:2.8
Aperture	F2.8 ~ Close
Angle of View (1")	6.6° x 6.6°
M.O.D	2000 mm
TV Distortion (1")	0.08 %
Operation	Manual(Lock screw M1.7)
Wavelength	Visible
Mount	C-Mount
Flange Back	17.526 mm
Sensor Size (max.)	1"
Filter Thread	M 37.5 P = 0.5
Weight (approx.)	104 g
Dimension	φ39(max.) x L = 66.5 mm

Megapixel Compact Model

CVL-0914M

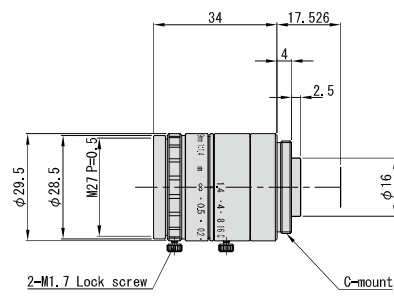

Focal Length (f)	9mm
Maximum Aperture Ratio	1:1.4
Aperture	F1.4 ~ Close
Angle of View (2/3")	43.4° x 51.0°
M.O.D	100 mm
TV Distortion (2/3")	-1.94 %
Operation	Manual(Lock screw M1.7)
Wavelength	Visible
Mount	C-Mount
Flange Back	17.526 mm
Sensor Size (max.)	2/3"
Filter Thread	M 27 P = 0,5
Weight (approx.)	54 g
Dimension	φ29.5(max.) x L = 34 mm

CVL-1214M

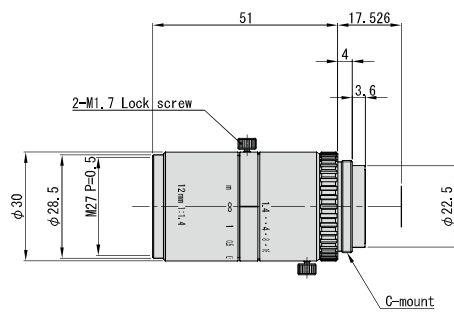

Focal Length (f)	12 mm
Maximum Aperture Ratio	1:1.4
Aperture	F1.4 ~ 16
Angle of View (2/3")	32.4° x 37.9°
M.O.D	100 mm
TV Distortion (2/3")	0.06 %
Operation	Manual(Lock screw M1.7)
Wavelength	Visible
Mount	C-Mount
Flange Back	17.526 mm
Sensor Size (max.)	2/3"
Filter Thread	M 27 P = 0,5
Weight (approx.)	80 g
Dimension	φ30(max.) x L = 51 mm

CVL-1614M

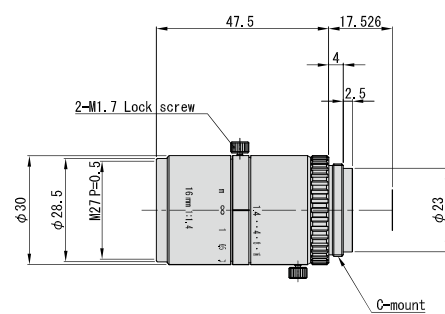

Focal Length (f)	16 mm
Maximum Aperture Ratio	1:1.4
Aperture	F1.4 ~ 16
Angle of View (2/3")	24.8° x 29.2°
M.O.D	100 mm
TV Distortion (2/3")	-0.16 %
Operation	Manual(Lock screw M1.7)
Wavelength	Visible
Mount	C-Mount
Flange Back	17.526 mm
Sensor Size (max.)	2/3"
Filter Thread	M 27 P = 0,5
Weight (approx.)	76 g
Dimension	φ30(max.) x L = 47.5 mm

CVL-5026M

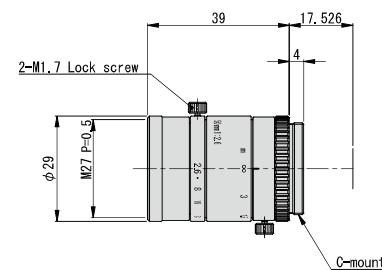

Focal Length (f)	50 mm
Maximum Aperture Ratio	1:2.6
Aperture	F2.6 ~ Close
Angle of View (2/3")	8.1° x 9.6°
M.O.D	500 mm
TV Distortion (2/3")	0.01 %
Operation	Manual(Lock screw M1.7)
Wavelength	Visible
Mount	C-Mount
Flange Back	17.526 mm
Sensor Size (max.)	2/3"
Filter Thread	M 27 P = 0,5
Weight (approx.)	54 g
Dimension	φ29(max.) x L = 39 mm

10MP Fixed Focal Length Lens

CVL-1628M10M 2/3" 1/1.8"

This particular lens was specifically made to deliver the most optimal resolution for any camera supporting up to a 2/3" sensor. Its 200lp/mm resolution is maintained from the center of the lens, to its very edge. With reduced shading and distortion, in terms of resolution, this lens simply cannot be beaten.



- Features**
- 2/3" sensor support
 - 200lp/mm resolution
 - 10MP
 - Reduced Shading
 - Minimized Distortion

CVL-1628M10M

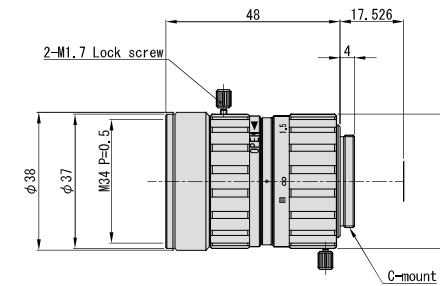

Focal Length (f)	16 mm
Maximum Aperture Ratio	1:2.8
Aperture	F2.8 ~ 22
Angle of view (2/3")	24.9° x 29.3°
M.O.D	350 mm
TV distortion (2/3")	-0.02 %
Operation	Manual(Lock screw M1.7)
Wavelength	Visible
Mount	C-Mount
Flange back	17.526 mm
Sensor size (max.)	2/3"
Filter Thread	M 34 P = 0,5
Weight (approx.)	106 g
Dimension	φ38(max.) x L = 48 mm

Lens for S-Mount Board Cameras

CVL-B Series

The CVL-B series features an S-mount capable lens compactly designed for use with board cameras.



- Features**
- 1/2" sensor support
 - S - Mount

CVL-B0624M

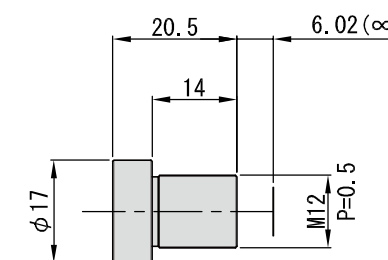

Focal Length	6 mm
Maximum Aperture Ratio	1:2.4
Angle of view (1/2")	43.5° x 56.0°
Back Focus	6.96 mm
Mechanical back	6.02 mm
Mount	M 12 P = 0,5
TV distortion (1/2")	-2.71 %
Sensor size (max.)	1/2"
Weight (approx.)	8 g
Dimension	φ17(max.) x L = 20.5 mm

1" Fixed Focal Length Lenses

CVL-M1 Series 1" 1/1.2"

The upgraded version of our CVL-M1 series to increase the sensor size support to 1". With its high resolution it is very effective for a large variety of machine vision applications. A core focus of the design was to minimize distortion while maintaining a high contrast in order to deliver the best possible image by a fixed focal length lens.

- Features**
- 1" sensor support
 - 9 models available
 - Focal length 6 - 100mm
 - F1.4 brightness
 - Low Distortion
 - High Contrast



Table for WD, FOV and Extension Tube Length

Extension Tube (mm)	Model Focal Length Focus	CVL-1214M1 f12 ∞~300		CVL-1614M1 f16 ∞~300		CVL-2514M1 f25 ∞~300		CVL-3514M1 f35 ∞~300		CVL-5018M1 f50 ∞~500	
		0	WD	300	300	300	300	300	300	300	500
	1"	296.3x296.3	212.5x212.5	137.3x137.3	95.4x95.4	111.5x111.5					
	2/3"	186.8x221.1	134.0x158.5	86.6x102.4	60.2x71.2	70.3x83.2					
	Mag.	0.038x	0.053x	0.082x	0.118x	0.101x					
0.5	WD	277.3	134.0	521.3	187.6	1262.1	240.3	2508.7	267.8	4997.4	454.6
	1"	274.6x274.6	140.8x140.8	363.2x363.2	134.0x134.0	563.0x563.0	110.4x110.4	804.3x804.3	85.3x85.3	1126.0x1126.0	101.4x101.4
	2/3"	173.2x204.9	88.8x105.0	229.0x271.0	84.5x100.0	355.0x420.0	69.6x82.4	507.1x600.0	53.8x63.6	710.0x840.0	64.0x75.7
	Mag.	0.041x	0.080x	0.031x	0.084x	0.020x	0.102x	0.014x	0.132x	0.010x	0.111x
1	WD	128.5	82.9	261.2	136.3	642.9	199.5	1255.3	242.3	2501.1	417.4
	1"	135.7x135.7	93.1x93.1	184.6x184.6	98.8x98.8	288.7x288.7	92.3x92.3	402.1x402.1	77.1x77.1	563.0x563.0	93.1x93.1
	2/3"	85.5x101.2	58.7x69.4	116.4x137.7	62.3x73.7	182.1x215.4	58.2x68.9	253.6x300.0	48.6x57.5	355.0x420.0	58.7x69.4
	Mag.	0.083x	0.121x	0.061x	0.114x	0.039x	0.122x	0.028x	0.146x	0.020x	0.121x
1.5	WD	80.5	57.7	170.7	105.6	421.9	171.4	818.1	221.2	1669.0	385.9
	1"	90.8x90.8	69.5x69.5	122.4x122.4	77.7x77.7	190.8x190.8	79.9x79.9	261.9x261.9	70.4x70.4	375.3x375.3	86.0x86.0
	2/3"	57.3x67.7	43.8x51.9	77.2x91.3	49.0x57.9	120.3x142.4	50.4x59.6	165.1x195.3	44.4x52.5	236.7x280.0	54.2x64.1
	Mag.	0.124x	0.162x	0.092x	0.145x	0.059x	0.141x	0.043x	0.160x	0.030x	0.131x
2	WD	55.9	42.4	126.9	86.2	312.9	149.0	617.6	202.4	1253.0	358.9
	1"	67.8x67.8	55.2x55.2	92.3x92.3	64.3x64.3	142.5x142.5	69.9x69.9	197.5x197.5	64.3x64.3	281.5x281.5	79.9x79.9
	2/3"	42.8x50.6	34.8x41.2	58.2x68.9	40.6x48.0	89.9x106.3	44.1x52.2	124.6x147.4	40.6x48.0	177.5x210.0	50.4x59.6
	Mag.	0.166x	0.204x	0.122x	0.175x	0.079x	0.161x	0.057x	0.175x	0.040x	0.141x
5	WD			46.3	38.3	120.1	82.2	249.1	136.9	504.1	253.2
	1"			36.9x36.9	31.5x31.5	57.2x57.2	40.4x40.4	79.3x79.3	43.3x43.3	112.6x112.6	56.0x56.0
	2/3"			23.3x27.5	19.8x23.5	36.0x42.6	25.4x30.1	50.0x59.2	27.3x32.3	71.0x84.0	35.3x41.8
	Mag.			0.305x	0.358x	0.197x	0.279x	0.142x	0.260x	0.100x	0.201x
10	WD					55.8	44.5	125.0	89.0	254.4	170.7
	1"					28.7x28.7	23.7x23.7	39.5x39.5	27.9x27.9	56.3x56.3	37.4x37.4
	2/3"					18.1x21.4	14.9x17.6	24.9x29.5	17.6x20.8	35.5x42.0	23.6x27.9
	Mag.					0.393x	0.476x	0.285x	0.403x	0.200x	0.301x
15	WD							84.1	66.3	171.2	129.3
	1"							26.4x26.4	20.7x20.7	37.5x37.5	28.1x28.1
	2/3"							16.6x19.7	13.0x15.4	23.7x28.0	17.7x20.9
	Mag.							0.427x	0.545x	0.300x	0.401x
20	WD							63.5	52.9	129.3	104.5
	1"							19.8x19.8	16.4x16.4	28.1x28.1	22.5x22.5
	2/3"							12.5x14.7	10.3x12.2	17.7x20.9	14.2x16.8
	Mag.							0.570x	0.688x	0.401x	0.501x
25	WD							51.2	44.2	104.5	87.8
	1"							15.8x15.8	13.6x13.6	22.5x22.5	18.7x18.7
	2/3"							10.0x11.8	8.6x10.1	14.2x16.8	11.8x14.0
	Mag.							0.712x	0.830x	0.501x	0.602x
30	WD							42.9	38.0	87.9	75.9
	1"							13.2x13.2	11.6x11.6	18.7x18.7	16.0x16.0
	2/3"							8.3x9.8	7.3x8.6	11.8x14.0	10.1x12.0
	Mag.							0.855x	0.973x	0.601x	0.702x
35	WD							37.1	33.4	76.0	67.1
	1"							11.3x11.3	10.1x10.1	16.1x16.1	14.0x14.0
	2/3"							7.1x8.4	6.4x7.5	10.1x12.0	8.9x10.5
	Mag.							0.997x	1.115x	0.701x	0.802x
40	WD									67.1	60.2
	1"									14.1x14.1	12.5x12.5
	2/3"									8.9x10.5	7.9x9.3
	Mag.									0.801x	0.902x
45	WD									60.2	54.6
	1"									12.5x12.5	11.2x11.2
	2/3"									7.9x9.3	7.1x8.4
	Mag.									0.901x	1.002x
50	WD									54.7	50.1
	1"									11.2x11.2	10.2x10.2
	2/3"									7.1x8.4	6.4x7.6
	Mag.									1.001x	1.102x

Description of the table above

Extension Tube (mm)	Model Focal Length Focus	CVL-○○○○M1 (f)	
		0.5m~∞	
5	WD	103	130
	1"	14x19	19x25
	2/3"-5M	18x24	24x32
	Mag.	0.25x	0.20x

→ Object Distance(mm)
 → The distance between the object and the front of the lens
 → FOV with a 1/3" sensor
 → FOV with a 1/2" sensor
 → Optical Magnification
 ↓ Length of Extension Tube

CVL-0618M1 Floating System

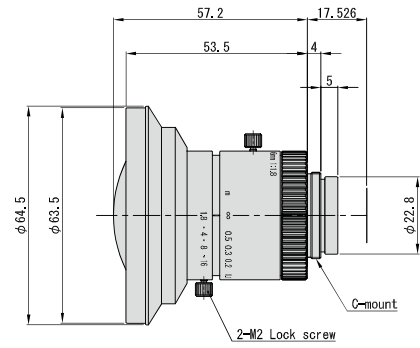

Focal Length (f)	6 mm
Maximum Aperture Ratio	1:1.8
Aperture	F1.8 ~ 16
Angle of View (1")	87.3° x 87.3°
M.O.D	100 mm
TV Distortion (1")	-0.61 %
Operation	Manual (Lock screw M2)
Wavelength	Visible
Mount	C-Mount
Flange Back	17.526 mm
Sensor Size (max.)	1"
Weight (approx.)	205 g
Dimension	φ64.5(max.) x L = 57.2 mm

CVL-0814M1

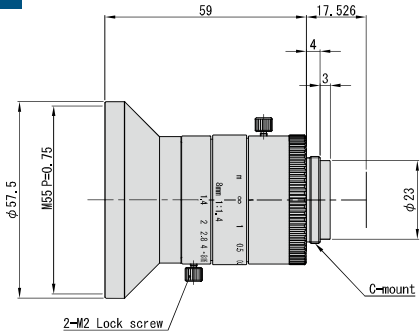

Focal Length (f)	8 mm
Maximum Aperture Ratio	1:1.4
Aperture	F1.4 ~ 16
Angle of View (1")	72.7° x 72.7°
M.O.D	100 mm
TV Distortion (1")	-0.35 %
Operation	Manual (Lock screw M2)
Wavelength	Visible
Mount	C-Mount
Flange Back	17.526 mm
Sensor Size (max.)	1"
Filter Thread	M 55 P = 0.75
Weight (approx.)	185 g
Dimension	φ57.5(max.) x L = 59 mm

CVL-1214M1

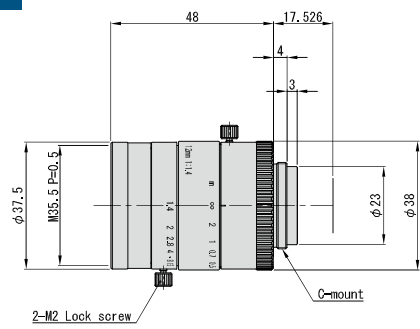

Focal Length (f)	12 mm
Maximum Aperture Ratio	1:1.4
Aperture	F1.4 ~ 16
Angle of View (1")	50.8° x 50.8°
M.O.D	300 mm
TV Distortion (1")	-0.32 %
Operation	Manual (Lock screw M2)
Wavelength	Visible
Mount	C-Mount
Flange Back	17.526 mm
Sensor Size (max.)	1"
Filter Thread	M 35.5 P = 0.5
Weight (approx.)	130 g
Dimension	φ38(max.) x L = 48 mm

CVL-1614M1

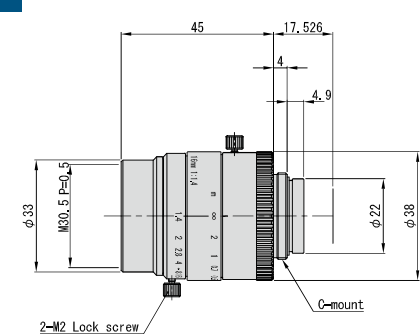

Focal Length (f)	16 mm
Maximum Aperture Ratio	1:1.4
Aperture	F1.4 ~ 16
Angle of View (1")	38.6° x 38.6°
M.O.D	300 mm
TV Distortion (1")	-0.65 %
Operation	Manual (Lock screw M2)
Wavelength	Visible
Mount	C-Mount
Flange Back	17.526 mm
Sensor Size (max.)	1"
Filter Thread	M 30.5 P = 0.5
Weight (approx.)	120 g
Dimension	φ38(max.) x L = 45 mm

CVL-2514M1

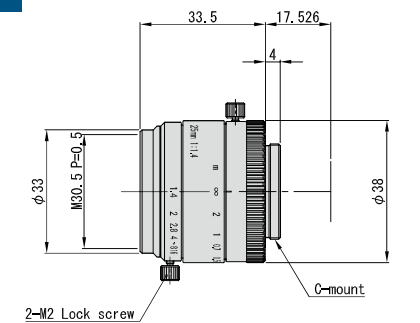

Focal Length (f)	25 mm
Maximum Aperture Ratio	1:1.4
Aperture	F1.4 ~ 16
Angle of View (1")	25.1° x 25.1°
M.O.D	300 mm
TV Distortion (1")	-0.46 %
Operation	Manual (Lock screw M2)
Wavelength	Visible
Mount	C-Mount
Flange Back	17.526 mm
Sensor Size (max.)	1"
Filter Thread	M 30.5 P = 0.5
Weight (approx.)	84 g
Dimension	φ38(max.) x L = 33.5 mm

CVL-3514M1

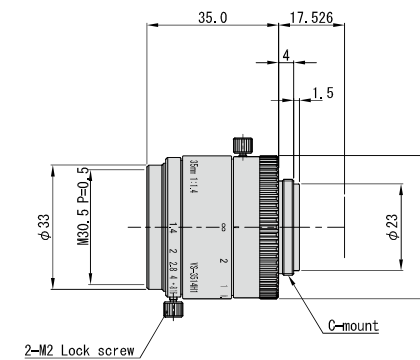

Focal Length (f)	35 mm
Maximum Aperture Ratio	1:1.4
Aperture	F1.4 ~ 16
Angle of View (1")	18.3° x 18.3°
M.O.D	300 mm
TV Distortion (1")	-0.31 %
Operation	Manual (Lock screw M2)
Wavelength	Visible
Mount	C-Mount
Flange Back	17.526 mm
Sensor Size (max.)	1"
Filter Thread	M 30.5 P = 0.5
Weight (approx.)	92 g
Dimension	φ38(max.) x L = 35 mm

CVL-5018M1

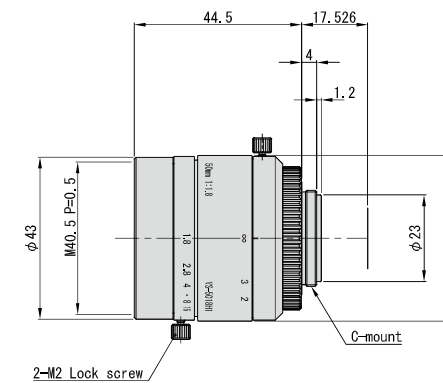

Focal Length (f)	50 mm
Maximum Aperture Ratio	1:1.8
Aperture	F1.8 ~ 16
Angle of View (1")	12.8° x 12.8°
M.O.D	500 mm
TV Distortion (1")	-0.01 %
Operation	Manual (Lock screw M2)
Wavelength	Visible
Mount	C-Mount
Flange Back	17.526 mm
Sensor Size (max.)	1"
Filter Thread	M 40.5 P = 0.5
Weight (approx.)	128 g
Dimension	φ44(max.) x L = 44.5 mm

CVL-7525M

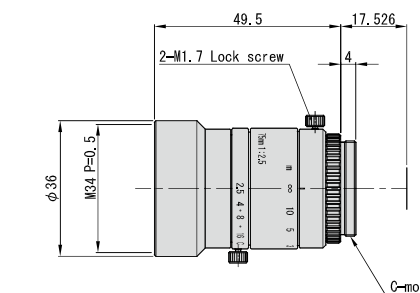

Focal Length (f)	75 mm
Maximum Aperture Ratio	1:2.5
Aperture	F2.5 ~ Close
Angle of View (1")	8.6° x 8.6°
M.O.D	1200 mm
TV Distortion (1")	0.05 %
Operation	Manual (Lock screw M1.7)
Wavelength	Visible
Mount	C-Mount
Flange Back	17.526 mm
Sensor Size (max.)	1"
Filter Thread	M 34 P = 0.5
Weight (approx.)	84 g
Dimension	φ36(max.) x L = 49.5 mm

CVL-10028M

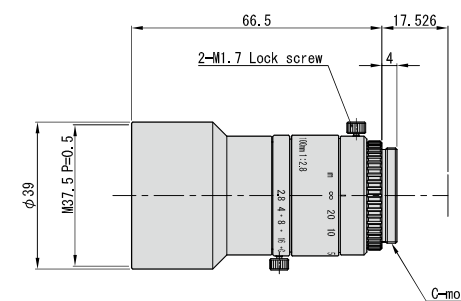

Focal Length (f)	100 mm
Maximum Aperture Ratio	1:2.8
Aperture	F2.8 ~ Close
Angle of View (1")	6.6° x 6.6°
M.O.D	2000 mm
TV Distortion (1")	0.08 %
Operation	Manual (Lock screw M1.7)
Wavelength	Visible
Mount	C-Mount
Flange Back	17.526 mm
Sensor Size (max.)	1"
Filter Thread	M 37.5 P = 0.5
Weight (approx.)	104 g
Dimension	φ39(max.) x L = 66.5 mm

CVL-IR11 Series 1.1" 1" 1/1.2"

Supports 1.1", 12MP and 4K resolution. IR-Corrected, minimize focus shift from visible to NIR.

Features

- Supports 12MP, 1.1" format and 3.45um
- 3 models available
- Focal length 12-25mm
- IR-Corrected, minimize focus shift from visible to NIR



CVL-1218-IR11

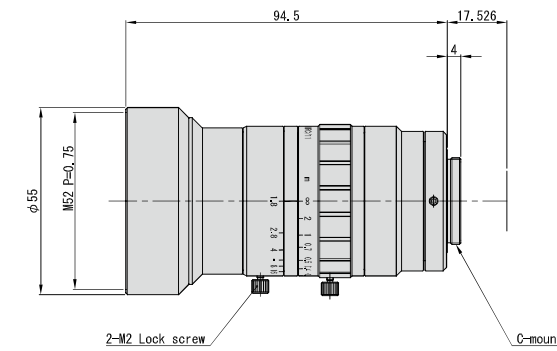

Focal Length (f)	12 mm
Maximum Aperture Ratio	1:1.8
Aperture	F1.8 ~ Close
Angle of View (1.1")	46.3° x 61.4°
M.O.D	300 mm
TV Distortion (1.1")	-1.37 %
Operation	Manual (Lock screw M2)
Wavelength	Visible ~ 850nm
Mount	C-Mount
Flange Back	17.526 mm
Sensor Size (max.)	1.1"
Filter Thread	M 52 P = 0.75
Weight (approx.)	340 g
Dimension	φ55(max.) x L = 94.5 mm

CVL-1618-IR11

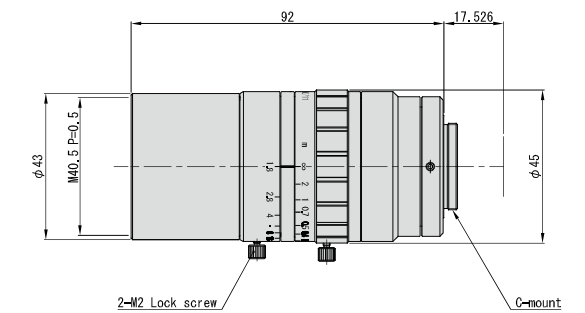

Focal Length (f)	16 mm
Maximum Aperture Ratio	1:1.8
Aperture	F1.8 ~ Close
Angle of View (1.1")	36.0° x 48.7°
M.O.D	300 mm
TV Distortion (1.1")	-1.95 %
Operation	Manual (Lock screw M2)
Wavelength	Visible ~ 850nm
Mount	C-Mount
Flange Back	17.526 mm
Sensor Size (max.)	1.1"
Filter Thread	M 40.5 P = 0.5
Weight (approx.)	290 g
Dimension	φ45(max.) x L = 92 mm

CVL-2518-IR11

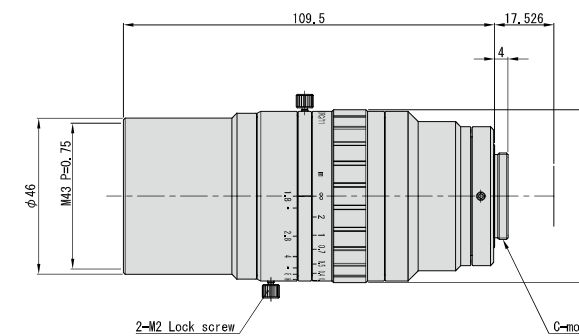

Focal Length (f)	25 mm
Maximum Aperture Ratio	1:1.8
Aperture	F1.8 ~ Close
Angle of View (1.1")	23.3° x 31.7°
M.O.D	300 mm
TV Distortion (1.1")	-1.00 %
Operation	Manual (Lock screw M2)
Wavelength	Visible ~ 850nm
Mount	C-Mount
Flange Back	17.526 mm
Sensor Size (max.)	1.1"
Filter Thread	M 43 P = 0.75
Weight (approx.)	390 g
Dimension	φ51(max.) x L = 109.5 mm

CVL-085 Series 4/3" 1.1" 1" 1/1.2"

High-speed cameras can best utilize the CVL-085 series due to its immensely bright F number of 0.85. Up to 4/3" sensors are supported as well as C and M42 mounts. An internally constructed floating system of lens elements allows the lens to produce a low distortion, high contrast image at any magnification.

Features

- 4/3" sensor support
- F0.85 brightness
- C & M42 mount
- Low Distortion
- High Contrast



CVL-25085 : Open Aperture

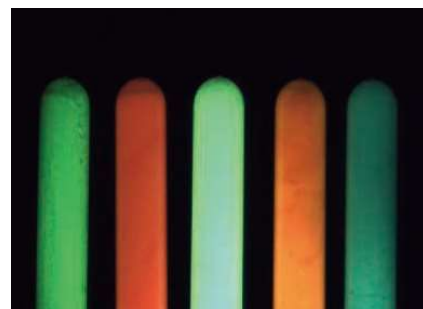

Standard CCTV lens : Open Aperture

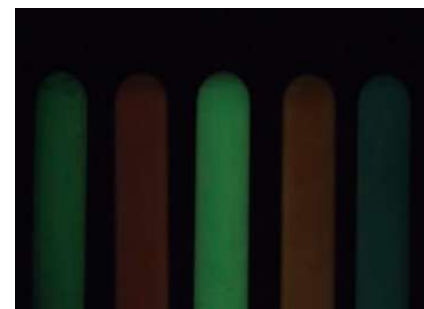

CVL-25085M42 Floating System

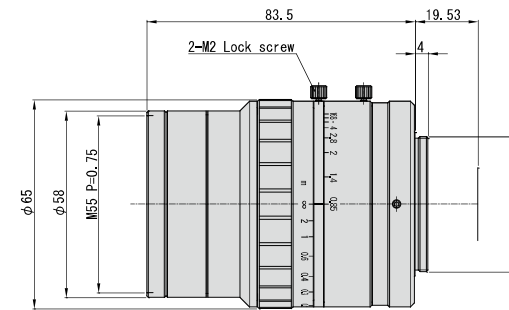

Focal Length (f)	25 mm
Maximum Aperture Ratio	1:0.85
Aperture	F0.85 ~ 16
Angle of View (4/3")	30.3° x 40.0°
M.O.D	170 mm
TV Distortion (4/3")	-1.21 %
Operation	Manual(Lock screw M2)
Wavelength	Visible
Mount	M 42 P = 1.0
Flange Back	19.53 mm
Sensor Size (max.)	4/3"
Filter Thread	M 55 P = 0.75
Weight (approx.)	570 g
Dimension	φ65(max.) x L = 83.5 mm

*C-mount's maximum aperture ratio is 1:090

CVL-25085C Floating System

BTO

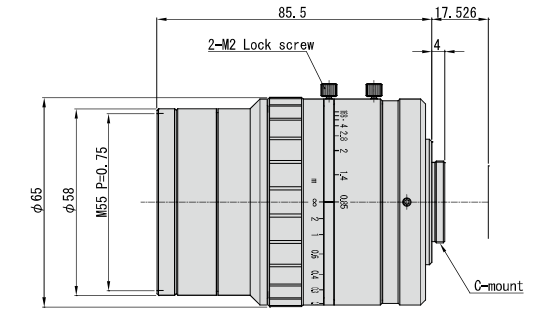

CVL-50085M42 Floating System

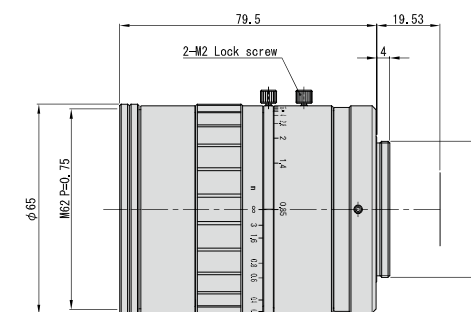

Focal Length (f)	50 mm
Maximum Aperture Ratio	1:0.85
Aperture	F0.85 ~ 16
Angle of View (4/3")	15.9° x 21.0°
M.O.D	240 mm
TV Distortion (4/3")	-0.30 %
Operation	Manual(Lock screw M2)
Wavelength	Visible
Mount	M 42 P = 1.0
Flange Back	19.53 mm
Sensor Size (max.)	4/3"
Filter Thread	M 62 P = 0.75
Weight (approx.)	610 g
Dimension	φ65(max.) x L = 79.5 mm

*C-mount's maximum aperture ratio is 1:090

CVL-50085C Floating System

BTO

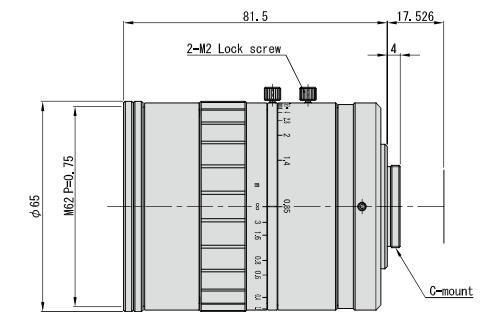

CVL-3CM OS Series 1/1.8"

Designed for multi sensor 3 CMOS cameras.

Features

- 1/1.8", 3.2MP and 3.45um sensor support
- 3 models available
- Focal length 8-25mm



CVL-0818-3CM

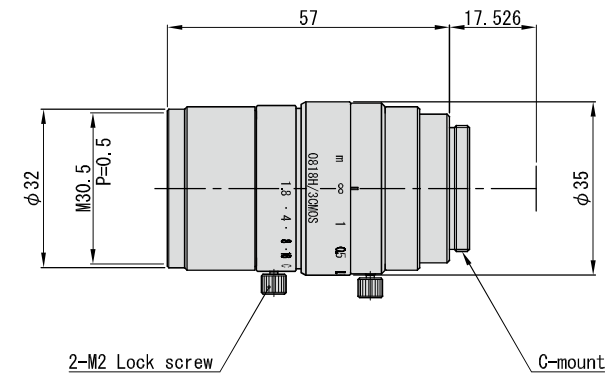

Focal Length (f)	8 mm
Maximum Aperture Ratio	1:1.8
Aperture	F1.8 ~ Close
Angle of View (1/1.8")	36.6° x 47.3°
M.O.D	100 mm
TV Distortion (1/1.8")	-0.81 %
Operation	Manual(Lock screw M2)
Wavelength	Visible
Mount	C-Mount
Flange Back	17526 mm
Sensor Size (max.)	1/1.8"
Filter Thread	M 30.5 P = 0.5
Weight (approx.)	110 g
Dimension	φ35(max.) x L = 57 mm

CVL-1218-3CM

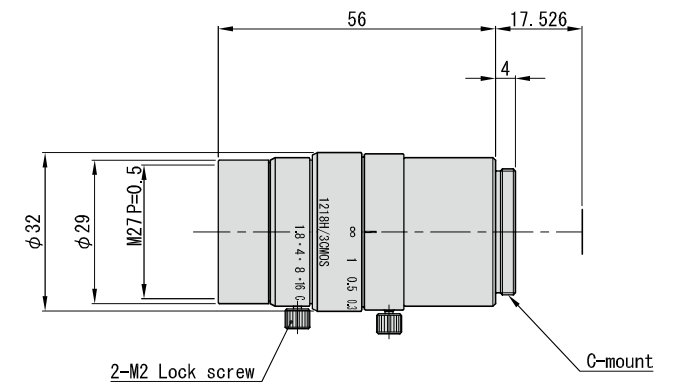

Focal Length (f)	12 mm
Maximum Aperture Ratio	1:1.8
Aperture	F1.8 ~ Close
Angle of View (1/1.8")	25.4° x 33.2°
M.O.D	150 mm
TV Distortion (1/1.8")	-0.80 %
Operation	Manual(Lock screw M2)
Wavelength	Visible
Mount	C-Mount
Flange Back	17526 mm
Sensor Size (max.)	1/1.8"
Filter Thread	M 27 P = 0.5
Weight (approx.)	94 g
Dimension	φ32(max.) x L = 56 mm

CVL-1618-3CM

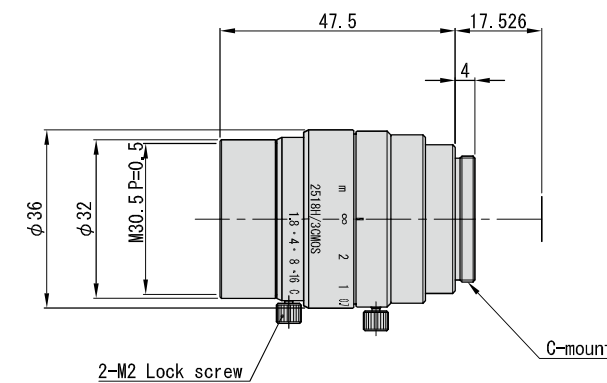

Focal Length (f)	25 mm
Maximum Aperture Ratio	1:1.8
Aperture	F1.8 ~ Close
Angle of View (1/1.8")	12.2° x 16.0°
M.O.D	200 mm
TV Distortion (1/1.8")	-0.16 %
Operation	Manual(Lock screw M2)
Wavelength	Visible
Mount	C-Mount
Flange Back	17526 mm
Sensor Size (max.)	1/1.8"
Filter Thread	M 30.5 P = 0.5
Weight (approx.)	100 g
Dimension	φ36(max.) x L = 47.5 mm

Sample Image with single CMOS camera



Sample Image with 3 CMOS camera

