











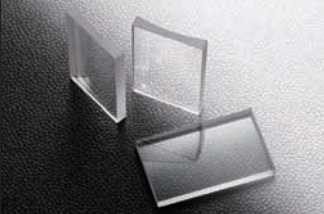

## Lens Holders Selection Guide

Lens holders are available for a wide variety of lens sizes and shapes .

		Fixed Type	Movable Type
Lenses		 FLH-S	 TFLH
Cylindrical lenses		 ACLH	
Objective lenses		 OLH	 Two-axis pinholes/objective holders TPOH + Adapters TPOH180A
Focusing lenses		 FLH-M FLH-UDL	
Small diameter lenses		 SLC/SLC-SF	 Two-axis pinholes/objective holders FOP + SLC-10ADP-2 + SLC-SF

Lens holders that can hold a range of different size lenses are also available.



CVLH



ARLH

Application Systems

Machine Vision

Manual Positions

Motion Control Products

Optical & Mirror Holder

FA Parts

Measurement & Control

FA Electrical Parts

Tool & Measure

Cleanroom & AntiStatic

Index

Mirrors

Beamsplitters

Filters

Polarizers

Lenses

Multi-Element Optics

Prisms

Substrates & Windows

Holder & Vibration Isolator

## NEW Fixed Lens Holders

## FLH-S

With a smaller diameter than traditional lens holders, these are best suited for optical systems where the holders need to be placed close together or have folded beam paths passing close by.

- ▶ To set the optical axis height from the baseplate to round figures such as 55mm or 60mm, replace posts with post stands (PS-\*\*).
- ▶ The inch screw thread mounting side allows the height setting in inches.
- ▶ Delrin retaining rings fix lenses securely without scratching them.



### Guide

- ▶ Post length can be changed. (If the length of post is specified at the time of purchase, this product will be delivered after replacing posts. Post replacement is gratis, but consult our International Sales Division because there may be extra charges due to differences in length.)
- ▶ With adapter nuts for conversion, posts with an M4 external thread or 8-32UNC posts can be mounted. Contact our International Sales Division for more information of adapter nuts for conversion.
- ▶ Holders (FLH) for  $\phi 80$ mm or larger lenses are also available.

[WEB Reference](#) [Catalog Code](#) W4516

### Attention

- ▶ Friction with the main unit may cause resin powder from Delrin retaining rings.
- ▶ For use in clean rooms or high-power lasers, replace with aluminum retaining rings (RDW-\*\*).



### Outline Drawing

#### FLH-10S/15S/20S

M6 P1

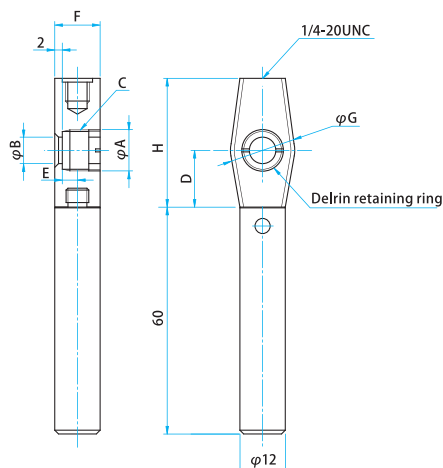

#### FLH-25S/25.4S/30S/30AS/40S/40AS/50S/50AS/50.8S/60AS

M6 P1

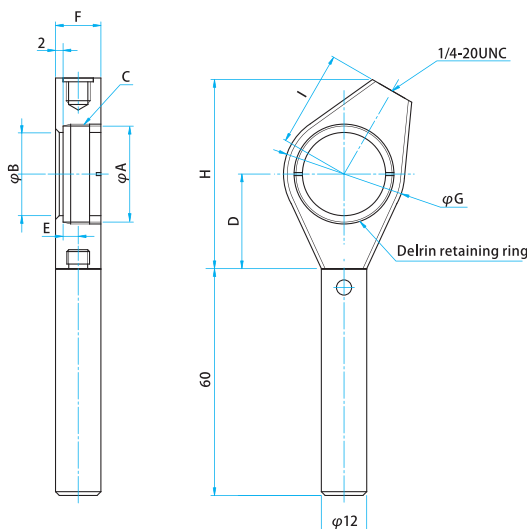

### Specifications

Specifications											Primary material: Aluminum Finish: Black Anodized
Part Number	Compatible Optics Diameter $\phi A$ [mm]	Clear Aperture $\phi B$ [mm]	C [mm]	D [mm]	E [mm]	F [mm]	$\phi G$ [mm]	H [mm]	I [mm]	Compatible Optics Thickness [mm]	Weight [kg]
FLH-10S	10	7	M10.85 P0.75	15	4	12	17	34.05	—	2 – 7	0.06
FLH-15S	15	12	M15.85 P0.75	20	5	15	20	39.05	—	2 – 10	0.07
FLH-20S	20	17	M20.85 P0.75	20	7	18	27	39.05	—	2 – 13	0.08
FLH-25S	25	22	M25.85 P0.75	25	6	16	32	50	25.4	2 – 11	0.09
FLH-25.4S	25.4	22	M26.25 P0.75	25	4	12	32	50	25.4	2 – 7	0.08
FLH-30S	30	26	M30.85 P0.75	25	4	12	36	50	25.4	2 – 7	0.09
FLH-30AS	30	26	M30.85 P0.75	25	7	18	36	50	25.4	3 – 12	0.11
FLH-40S	40	37	M40.85 P0.75	30	7	18	46	66	38.1	2 – 13	0.11
FLH-40AS	40	37	M40.85 P0.75	30	8	20	46	66	38.1	3 – 15	0.12
FLH-50S	50	46	M50.85 P0.75	35	7	18	57	71	38.1	3 – 13	0.11
FLH-50AS	50	46	M50.85 P0.75	35	10	24	57	71	38.1	3 – 19	0.13
FLH-50.8S	50.8	47	M51.65 P0.75	35	7	18	58	71	38.1	2 – 13	0.11
FLH-60AS	60	56	M60.85 P0.75	40	13.5	27	67	76	38.1	3 – 16	0.13

Application Systems

Machine Vision

Manual Positions

Motion Control Products

Optical & Mirror Holder

F A Parts

Measurement & Control

FA Electrical Parts

Tool & Measure

Cleanroom & AntiStatic

Index

Mirrors

Beamsplitters

Filters

Polarizers

Lenses

Multi-Element Optics

Prisms

Substrates & Windows

Holder & Vibration isolator