

XZ axis Rack and Pinion Dovetail Stages

MLT04-L **RoHS**

Rack and pinion stages with dovetail slides, suitable for frequent operations that require quick motion and long travel.



Guide

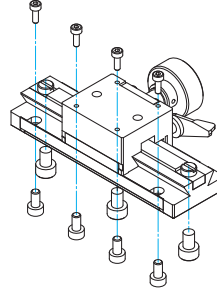

■ Mounting Method of MLT04-2550L
Use M3 pan head screws (only on both edges) to secure from the top, and M4 pan head screws to secure from the bottom.

■ Components

Part Number	MLT04-2550L
Z axis	MLT73W-2550L
X axis	MLT71W-2550



Outline Drawing

MLT04-2550L □ Pan head screw M3x8...4 screws

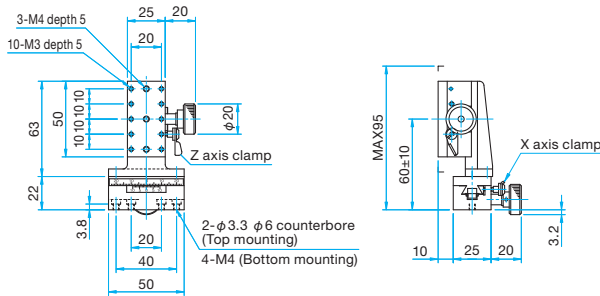

MLT04-3480L □ Hexagonal socket head cap screw M4x8...4 screws

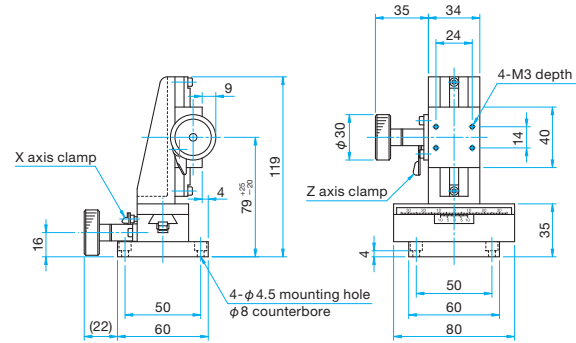

Bottom Plate

Primary material: Aluminum
Finish: Black Anodized

TAR-34804L include a base plate that allows mounting on instruments or bases fitted with M4 tapped holes on □50mm, preventing the handle from contacting the mounting surface.

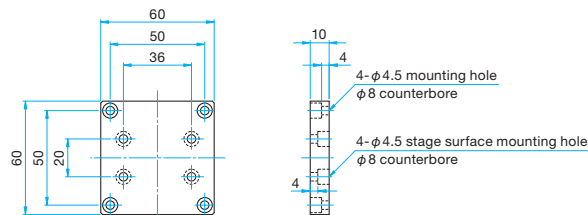

Specifications

Part Number		MLT04-2550L	MLT04-3480L
Table Size [mm]		25x50	34x40
Travel [mm]		X axis ±10, Z axis ±10	X axis ±25, Z axis +25/-20
Lead of Actuator [mm/rotation]		about 20	about 20
Positioning Slide		Dovetail slide method	Dovetail slide method
Primary Material		Brass	Brass
Finish		Super black chrome	Super black chrome
Load Capacity [N]		9.8 (1.0kgf)	14.7 (1.5kgf)
Travel Accuracy	Straightness [μm]	30	30
	Pitch [N·m]	0.5	0.5
Max. Moment Capacity	Yaw [N·m]	0.5	0.5
	Pitch [°/N·cm]	3.98	2
Weight [kg]		0.52	1.1

Application Systems

Machine Vision

Manual Positions

Motion Control Products

Optical & Mirror Holder

F A Parts

Measurement & Control

FA Electrical Parts

Tool & Measure

Cleanroom & AntiStatic

Index

X Axis

XY Axis

Z Axis

XZ Axis

XYZ Axis

Rotation

Goniometers /Tilt

Multiaxis

Linear Guide

□15mm

□25mm

□40mm

□50mm

□60mm

□70mm

□80mm

□100mm

□120mm

Others