

Provides diffused light from an angled emitting surface



Applications

Soldering inspection, parts identification with color, inspection for stains on glossy surfaces, character recognition on metal parts, dent inspection on metal parts, etc.

Features

LEDs embedded around a circular light-guiding diffusion plate. Uniformly diffused light from an emitting surface angled with respect to the workpiece.

Example configuration (LKR-125)

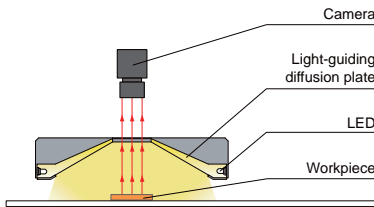

We accept custom orders. Please feel free to inquire.

- Shape modifications
- Brightness increases
- Changes in wavelength, etc.

Imaging example: Imaging soldering parts on the cap of light bulbs



Workpiece: Light bulbs



LED Diffused Lighting



It is difficult to evenly illuminate the whole solder.

LKR-125SW2



It is possible to evenly illuminate the whole solder, including the cap.

Data: Relative Irradiance Graph and Uniformity (Representative Example)

The data included is for reference only. Actual values may vary.

LKR-70RD2

Relative irradiance graph (LWD characteristics)^{*2}

*1 Irradiance on the optical axis
*2 Illuminating distance from the Light Unit to the workpiece

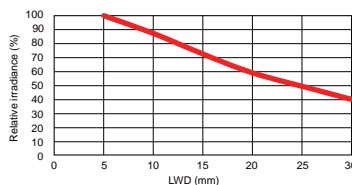

Uniformity (Relative irradiance)

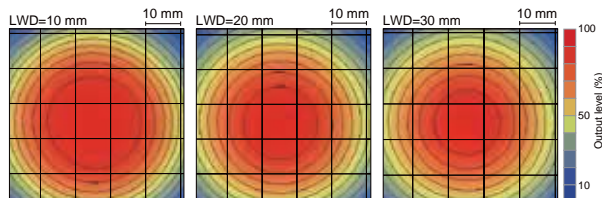

Lineup

Model name	LED color	Power consumption	Peak wavelength / correlated color temperature	Options	Extension cables	Recommended Control Units	Weight					
LKR-70RD2	Red	24 V / 2.6 W	630 nm	-	FCB* ² Straight Cable	<table border="1"> <tr> <td>PD3</td> <td>CC-ST-1024</td> </tr> <tr> <td>PSB</td> <td>POD*¹</td> </tr> </table>	PD3	CC-ST-1024	PSB	POD* ¹	125 g	
PD3	CC-ST-1024											
PSB	POD* ¹											
LKR-70SW2	White	5,500 K	130 g									
LKR-70BL2	Blue	24 V / 3.8 W	470 nm		FCB-W* ³ 2-branch Cable		125 g					
LKR-70GR2	Green		525 nm									
LKR-70-8RD2	Red	24 V / 2.6 W	630 nm		FCB-F 4-branch Cable		<table border="1"> <tr> <td>PD3</td> <td>CC-ST-1024</td> </tr> <tr> <td>PSB</td> <td>POD*¹</td> </tr> </table>	PD3	CC-ST-1024	PSB	POD* ¹	140 g
PD3	CC-ST-1024											
PSB	POD* ¹											
LKR-70-8SW2	White	5,500 K										
LKR-70-8BL2	Blue	24 V / 3.8 W	470 nm		FRCB Robot Cable							
LKR-70-8GR2	Green		525 nm									
LKR-125RD2	Red	24 V / 4.6 W	630 nm	<p>*2 The cables with a model name that ends with "-ME7", "-EL2", "-PF", or "-PF-EL9" are not included.</p> <p>*3 The cables with a model name that ends with "-EL2" are not included.</p>	295 g							
LKR-125SW2	White		5,500 K		300 g							
LKR-125BL2	Blue	24 V / 5.7 W	470 nm		490 g							
LKR-125GR2	Green		525 nm									

Extension Cables ▶ P.308

Control Unit Selection Guide ▶ P.251

List of Control Unit Specifications ▶ P.253

LED Properties

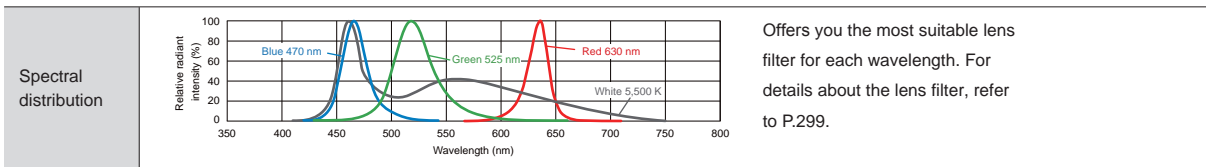

Be sure to read the "Instruction Guide" included with the product before use and follow the safety precautions upon use. The data included is for reference only. Actual values may vary.

Dimensions (mm)

LKR-70RD2/SW2/BL2/GR2

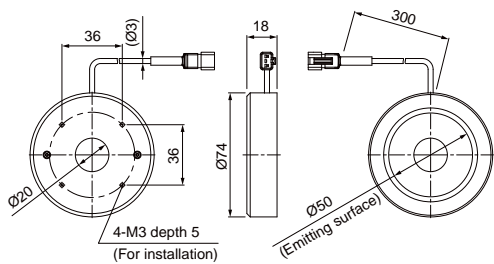

LKR-70-8RD2/SW2/BL2/GR2

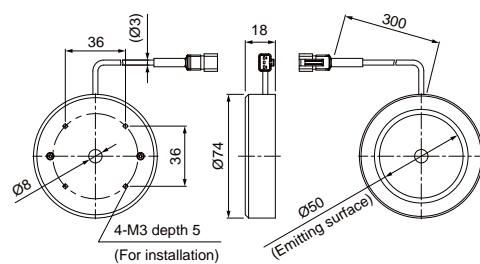

The emitting surface for the LKR-70-8SW2/BL2/GR2 is Ø49.2.

LKR-125RD2/SW2/BL2/GR2

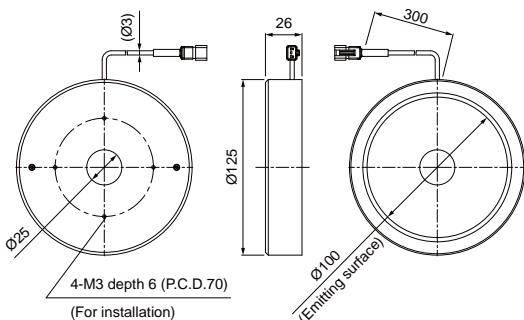

You can change the connectors of the Light Unit cable. Choose between M12 connectors and flying leads. Refer to P.5 for details.

- Direct Lighting
 - LDR2
 - LDR2-LA
 - LDR-LA1
 - SQR
 - SQR-TP
 - HPR2
- Diffused Lighting
 - LFR
 - LKR
 - FPR
 - FPQ2
- Direct Lighting
 - LDL2
 - LDLB
 - HLDL2
 - HL
- Diffused Lighting
 - TH2 (5 types)
 - TH
 - LFL
 - HPD2
 - LDM2
 - LAV
 - PDM
 - LFX3
 - LFX3-PT
 - LFV3
- Colimated Lighting
 - MSU
 - MFU
- Strobe Lighting
 - PF
- Water-proof Lighting
 - HLDR-IP/
 - HSL-PCL
- Ultraviolet Lighting
 - UV2
 - UV
 - LNSP-UV-FN
- Infrared Control Lighting
 - IR2
 - IU
- Spot Lighting, Etc.
 - HLV3
 - HLV2
 - LV
 - LSP
 - HFS/HFR
 - HLV3-NR
 - HLV3-3M-RGB-4
 - HLV2-NR
 - HLV2-3M-RGB-3W
 - PFBR
 - PFB3
 - PFB2
- Convergent Lighting
 - LNLP
 - LNSP2
 - LNSP
 - Coaxial Units
 - LNSP-FN
 - LN/LN-HK
- Diffused Lighting
 - LNSD
 - LND2
 - HLND
 - LT
 - LNV
- Oblique-Angled Lighting
 - LNDG
 - LNIS2
 - LNIS
 - LNIS-FN
- Lenses
 - Telecentric Lens
 - Macro Lens