

Provides direct light at a low angle from an angled emitting part

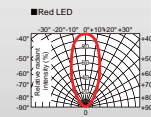

Applications Visual inspections for metal parts; inspection for damage or stains on electronic parts; inspection for damage to resin parts; inspection for damage to glass edges; inspection for damage to stain finishing; etc.

Features

Rings of surface-mounted LEDs mounted on a square case. Provides direct light at a low angle from an angled emitting part.

We accept custom orders. Please feel free to inquire.

- Shape modifications
- Brightness increases
- Changes in wavelength, etc.

Example configuration (SQR-TP-34RD)

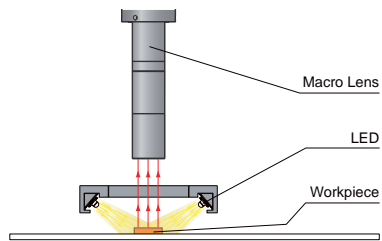

Imaging example: Imaging text on circuit boards

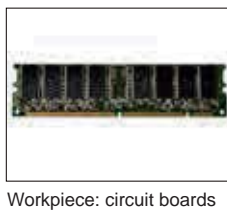

Workpiece: circuit boards

Macro lens + LED Spot Light



It is difficult to recognize the surface status using coaxial illumination.

SQR-TP-34RD



Can make an image of the text on the circuit board, the text on the chip, and the soldering plating.

Lineup

Model name	LED color	Power consumption	Peak wavelength	Options	Extension cables	Recommended Control Units	Weight
SQR-TP-28RD	Red	24 V / 0.5 W	638 nm	-	FCB ^{*2} Straight Cable FCB-W ^{*3} 2-branch Cable FCB-F 4-branch Cable FRCB Robot Cable	PD3 CC-ST-1024 PSB POD ^{*1}	15 g
SQR-TP-34RD		24 V / 0.9 W					

LED Properties: Spectral Distribution ▶ P.326

Extension Cables ▶ P.308

Control Unit Selection Guide ▶ P.251

List of Control Unit Specifications ▶ P.253

*1 The cables with a model name that ends with "-ME7", "-EL2", "-PF", or "-PF-EL9" are not included.

*2 The cables with a model name that ends with "-EL2" are not included.

Dimensions (mm)

SQR-TP-28RD

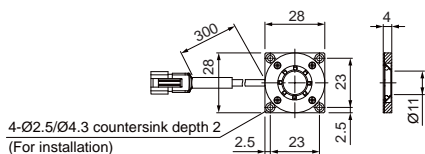

SQR-TP-34RD

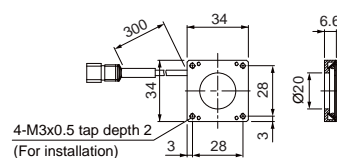

You can change the connectors of the Light Unit cable. Choose between M12 connectors and flying leads. Refer to P.5 for details.

You can inquire using our website.

- Sample Testing
- Light Unit Selection
- Free Product Trial
- Custom Orders
- Product Details
- Pricing/Quotation
- Discontinued Products

Direct Lighting

- LDR2
- LDR2-LA
- LDR-LA1
- SQR
- SQR-TP

Diffused Lighting

- HPR2
- LFR
- LKR
- FPR
- FPQ2

Direct Lighting

- LDL2
- LDLB
- HLDL2
- HL

Diffused Lighting

- TH2 (5 types)
- TH
- LFL
- HPD2
- LDM2
- LAV
- PDM
- LFX3
- LFX3-PT
- LFV3

Collimated Lighting

- MSU
- MFU

Strobe Lighting

- PF

Water-proof Lighting

- HLDR-IP/
- HSL-PCL

Ultraviolet Lighting

- UV2
- UV
- LNSP-UV-FN

Infrared Control Lighting

- IR2
- IU

Spot Lighting, Etc.

- HLV3
- HLV2
- LV
- LSP
- HFS/HFR
- HLV3-NR
- HLV3-3M-RGB-4
- HLV2-NR
- HLV2-3M-RGB-3W
- PFBR
- PFB3
- PFB2

Convergent Lighting

- LNL
- LNSP2
- LNSP
- Coaxial Units
- LNSP-FN
- LN/LN-HK

Diffused Lighting

- LNSD
- LND2
- HLND
- LT

Oblique/Angled Lighting

- LNV
- LNDG
- LNS2
- LNIS
- LNIS-FN

Lenses

- Telecentric Lens
- Macro Lens