

CHCPM-3100M

31 MP CMOS CoaXPress Area Scan Camera



GEN*<i>*CAM

CoaXPress®

Introduction

CHCPM-3100M camera adopts Sony IMX 342 sensor and provides high quality image. It transmits data via CXP-6 interface. With high dynamic range and high signal-noise ratio, it is widely applied to PCB AOI, FPD, high-accuracy measurement, etc.

Key Feature

- Resolution 6464 × 4852, and pixel size 3.45 μm × 3.45 μm
- Adopts CMOS global shutter to provide high dynamic range, SNR and high quality image
- Adopts CXP-6 interface to transmit data
- Compatible with CoaXPress Protocol, and GenICam standard

Available Model

Mono camera: CHCPM-3100M

Applicable Industry

PCB AOI, FPD, high-accuracy measurement, railway related application, etc.

Sensor Quantum Efficiency

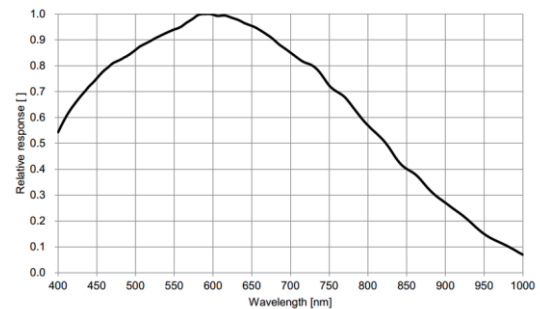

Dimension

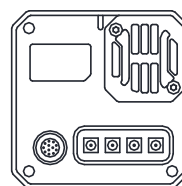
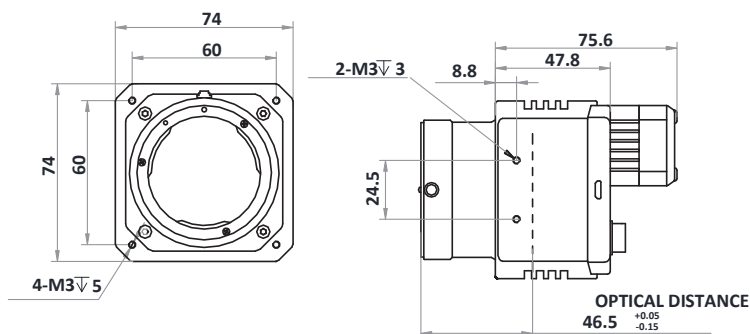

Unit: mm

HOURS
www.hours-web.com

Specification

| | |
|----------------------------|---|
| Model | CHCPM-3100M |
| Camera | |
| Sensor type | CMOS, global shutter |
| Sensor model | Sony IMX 342 |
| Pixel size | 3.45 μm \times 3.45 μm |
| Sensor size | APS-C |
| Resolution | 6464 \times 4852 |
| Max. frame rate | ADC 8bit mode: 17.9 fps @6464 \times 4852 ADC 12bit mode: 12.1 fps @6464 \times 4852 |
| Mono/color | Mono |
| Pixel format | ADC 8bit mode: Mono 8; ADC 12bit mode: Mono 8 / 10/ 12 |
| Dynamic range | 73 dB |
| SNR | 40 dB |
| Gain | 0 dB to 20 dB |
| Exposure time | UltraShort exposure mode: 3 μs to 33 μs ADC 8bit mode: 47 μs to 2 s ADC 12bit mode: 36 μs to 2 s |
| Shutter mode | Off/ Once /Continuous exposure mode |
| Reverse image | Supports horizontal and vertical reverse image output |
| Electrical features | |
| Data interface | CoaXPress (DIN interface) |
| Digital I/O | 12-pin I/O interface; opto-isolated input x1 (Line 0), opto-isolated output x1 (Line 1), bi-directional non-isolated I/O x 1 (Line 2), RS-232 x1, and RS-485 interface x 1 |
| Power supply | 9 VDC to 26 VDC |
| Power consumption | < 9.1 W@12 VDC |
| Structure | |
| Lens mount | F-Mount, optical back focal length 46.5 mm (1.8") |
| Dimension | 74 mm \times 74 mm \times 75.6 mm (2.9" \times 2.9" \times 3.0") |
| Weight | Approx. 650 g (1.4 lb.) |
| Ingress protection | IP 40 (under proper lens installation and wiring) |
| Temperature | Working temperature: 0 $^{\circ}\text{C}$ to 50 $^{\circ}\text{C}$ (32 $^{\circ}\text{F}$ to 122 $^{\circ}\text{F}$) Storage temperature: -30 $^{\circ}\text{C}$ to 70 $^{\circ}\text{C}$ (-22 $^{\circ}\text{F}$ to 158 $^{\circ}\text{F}$) |
| Humidity | 20% to 95% RH, without condensation |
| General | |
| Client software | Frame grabber software meeting with CoaXPress Protocol |
| Operating system | 32/64-bit Windows 7/10 with 8 GB memory or above |
| Compatibility | CoaXPress, GenICam |
| Certification | CE, FCC, RoHS |