

# CHCM-1200C

12 MP 1.1" CMOS CameraLink Area Scan Camera



GEN*<i>i>*CAM



## Introduction

CHCM-120C camera adopts Sony® IMX253 sensor to provide high-quality image. It uses CameraLink interface to transmit non-compressed images in real time with max. frame rate reaching 68.1 fps in full resolution.

## Key Feature

- Adopts global shutter CMOS sensor providing wide dynamic range and high-quality image.
- Supports configuration modes of Base, Medium, Full and 80-bit via the CameraLink interface.
- Adopts compact design with mounting holes for flexible mounting.
- Compatible with CameraLink V2.0 Protocol, GenICam Standard, and the third-party software based on the protocol and standard.

## Available Model

Color Camera: CHCM-1200C

## Applicable Industry

SMT/ PCB AOI, FPD, high-accuracy measurement, etc.

## Sensor Quantum Efficiency

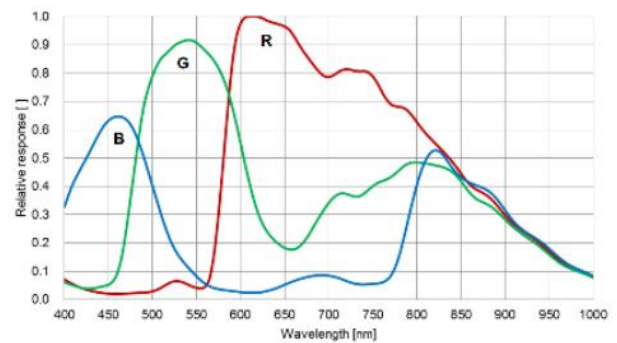

## Dimension

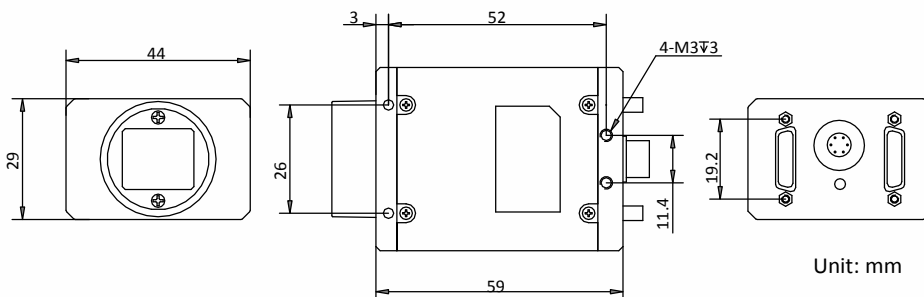

## Specification

<b>Model</b>	<b>CHCM-1200C</b>
<b>Camera</b>	
<b>Sensor type</b>	Global shutter CMOS
<b>Sensor model</b>	Sony® IMX253
<b>Pixel size</b>	3.45 µm × 3.45 µm
<b>Sensor size</b>	1.1"
<b>Max. resolution</b>	2 Taps, 4 Taps, 8 Taps: 4096 × 3000; 10 Taps: 3840 × 3000
<b>Pixel clock</b>	40 MHz, 60 MHz, 70 MHz, 85 MHz
<b>Configuration mode</b>	Base, Medium, Full, 80-bit
<b>Sensor combination</b>	1X_1Y, 1X2_1Y, 1X4_1Y, 1X8_1Y, 1X10_1Y
<b>Tap number</b>	1 Tap, 2 Taps, 4 Taps, 8 Taps, 10 Taps
<b>Max. frame rate</b>	51.4 fps @4096 × 3000 68.1 fps @3840 × 3000
<b>Pixel format</b>	Bayer RG 8/10/12, RGB 8
<b>Dynamic range</b>	71.6 dB
<b>SNR</b>	39.7 dB
<b>Gain</b>	0 dB to 24 dB
<b>Exposure time</b>	1 µs to 10 s
<b>Shutter mode</b>	Off/Once/Continuous exposure mode
<b>Mono/color</b>	Color
<b>Binning</b>	Not support
<b>Decimation</b>	Not support
<b>Reverse image</b>	Supports horizontal and vertical reverse image output
<b>Electrical features</b>	
<b>Data interface</b>	CameraLink with SDR interface
<b>Digital I/O</b>	6-pin Hirose connector provides power and I/O, including opto-isolated input x 1 (Line 0), opto-isolated output x 1 (Line 1), and bi-directional non-isolated I/O x 1 (Line 2).
<b>Power supply</b>	9 VDC to 24 VDC
<b>Power consumption</b>	Approx. 4.68 W@12 VDC
<b>Structure</b>	
<b>Lens mount</b>	C-mount
<b>Dimension</b>	44 mm × 29 mm × 59 mm (1.7" × 1.1" × 2.3")
<b>Weight</b>	Approx. 100 g (0.2 lb.)
<b>Ingress protection</b>	IP30 (under proper lens installation and wiring)
<b>Temperature</b>	Working temperature: 0 °C to 50 °C (32 °F to 122 °F) Storage temperature: -30 °C to 70 °C (-22 °F to 158 °F)
<b>Humidity</b>	20% to 80% RH, without condensation
<b>General</b>	
<b>Client software</b>	MVS or frame grabber software meeting with CameraLink V2.0, GenICam Protocol
<b>Operating system</b>	32/64-bit Windows 7/10
<b>Compatibility</b>	CameraLink V2.0, GenICam
<b>Certification</b>	CE, FCC, RoHS, KC