

CHTGM-1200M

12 MP 1.1" CMOS 10 GigE Area Scan Camera



GEN*i*CAM

10GigE
VISION

Introduction

CHTGM-1200M camera adopts Sony IMX253 sensor to provide high-quality image with high resolution and low noise. It uses 10 Gigabit Ethernet interface to transmit uncompressed data in real time with max. frame rate reaching 68 fps at full resolution.

Key Feature

- Resolution of 12 megapixel and pixel size of $3.45 \mu\text{m} \times 3.45 \mu\text{m}$
- Adopts 10 Gigabit Ethernet interface, compatible with Gigabit Ethernet, and max. transmission distance of 100 meters without delay
- Up to 1024 MB local memory for burst transmission and retransmission
- Compact design with mounting holes on the up and bottom panels for flexible mounting

Available Model

M58-mount with fan, Mono:
CHTGM-1200M-M58
F-mount with fan, Mono:
CHTGM-1200M-F

Applicable Industry

SMT automatic optical detection, PCB AOI, FPD, railway related application, etc.

Sensor Quantum Efficiency

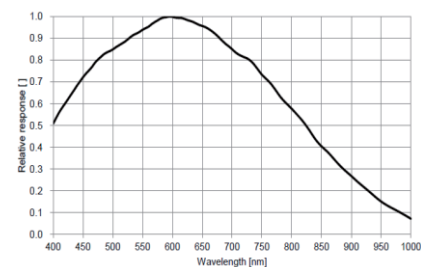

Dimension

M58-mount with fan:

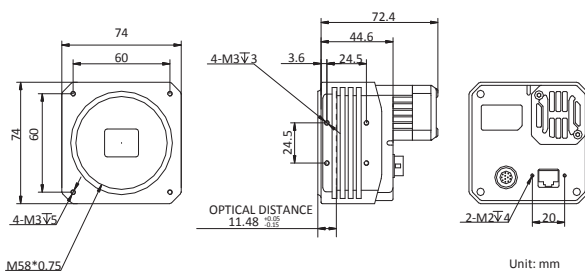

F-mount with fan:

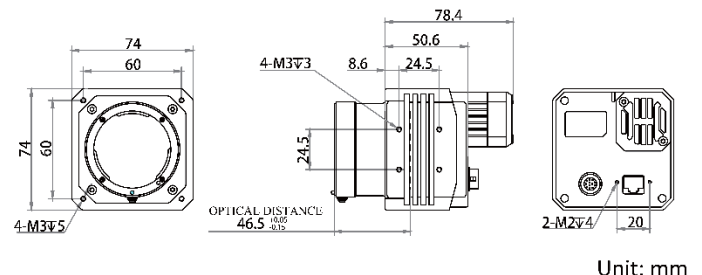

Specification

| | |
|----------------------------|---|
| Model | CHTGM-1200M |
| Camera | |
| Sensor type | CMOS, global shutter |
| Sensor model | Sony IMX253 |
| Pixel size | 3.45 μm \times 3.45 μm |
| Sensor size | 1.1" |
| Resolution | 4096 \times 3000 |
| Max. frame rate | 68 fps @4096 \times 3000 |
| Dynamic range | 70 dB |
| SNR | 40 dB |
| Gain | 0 dB to 15 dB \times |
| Exposure time | 2 μs to 10 s |
| Shutter mode | Off/Once/Continuous exposure mode |
| Mono/Color | Mono |
| Pixel format | Mono 8/10/10p/12/12p |
| Acquisition mode | Continuous mode and SingleFrame mode |
| Reverse image | Supports horizontal and vertical reverse image output |
| Image buffer | 1024 MB |
| Electrical features | |
| Data interface | 10 Gigabit Ethernet |
| Digital I/O | 12-pin I/O, including opto-isolated input \times 1 (Line0), opto-isolated output \times 1 (Line1), bi-directional non-isolated I/O \times 1 (Line2), RS232 \times 1 |
| Power supply | 12 VDC to 24 VDC |
| Power consumption | Approx. 11 W@12 VDC |
| Structure | |
| Lens mount | M58-mount, optical back focal length: 11.48 mm (0.45") F-Mount, optical back focal length: 46.5 mm (1.83") |
| Dimension | M58-mount with fan: 74 mm \times 74 mm \times 72.4 mm (2.91" \times 2.91" \times 2.85") F-mount with fan: 74 mm \times 74 mm \times 78.4 mm (2.91" \times 2.91" \times 3.09") |
| Weight | M58-Mount with fan: < 450 g (1.0 lb) F-Mount with fan: < 600 g (1.3 lb) |
| Ingress protection | IP30 (under proper lens installation and wiring) |
| Temperature | Working temperature: 0 $^{\circ}\text{C}$ to 50 $^{\circ}\text{C}$ (32 $^{\circ}\text{F}$ to 122 $^{\circ}\text{F}$) Storage temperature: -30 $^{\circ}\text{C}$ to 70 $^{\circ}\text{C}$ (-22 $^{\circ}\text{F}$ to 158 $^{\circ}\text{F}$) |
| Humidity | 20% to 95% RH, without condensation |
| General | |
| Client software | MVS or third-party software meeting with GigE Vision Protocol |
| Operating system | Windows XP/7/10 32/64-bit |
| Compatibility | GigE Vision, GenICam |
| Certification | CE, FCC, RoHS |