

# CHGM-884M

8.9 MP 1" CMOS GigE Area Scan Camera



GEN*i*CAM

**GigE**  
VISION

## Introduction

CHGM-884M camera adopts Sony® IMX267 sensor to provide high-quality image. It uses GigE interface to transmit non-compressed images in real time with max. frame rate reaching 13 fps in full resolution.

## Key Feature

- Adopts GigE interface and max. transmission distance of 100 meters without relay.
- Supports auto and manual adjustment for exposure control, LUT, Gamma correction, etc.
- Up to 128 MB local memory for burst transmission.
- Supports hardware trigger, software trigger, etc.
- Compatible with GigE Vision V2.0 Protocol, GenlCam Standard, and third-party software based on the protocol and standard.

## Available Model

CHGM-884M

## Applicable Industry

Electronic semiconductor, factory automation, food and beverage, medical packaging, etc.

## Sensor Quantum Efficiency

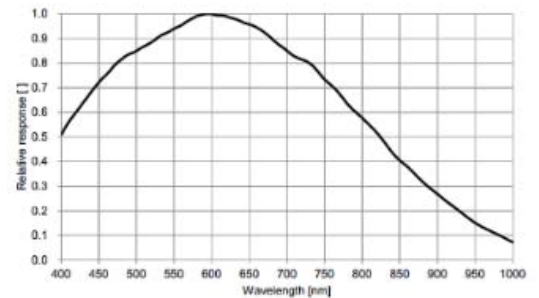

## Dimension

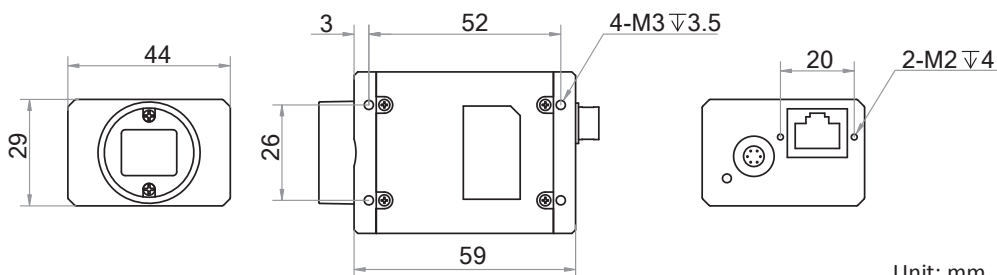

## Specification

<b>Model</b>	<b>CHGM-884M</b>
<b>Camera</b>	
<b>Sensor type</b>	Global shutter CMOS
<b>Sensor model</b>	Sony® IMX267
<b>Pixel size</b>	3.45 μm × 3.45 μm
<b>Sensor size</b>	1"
<b>Resolution</b>	4096 × 2160
<b>Max. frame rate</b>	13 fps @4096 × 2160
<b>Dynamic range</b>	72.5 dB
<b>SNR</b>	40.1 dB
<b>Gain</b>	0 dB to 20 dB
<b>Exposure time</b>	UltraShort exposure mode: 1 μs to 14 μs Standard exposure mode: 15 μs to 10 s
<b>Shutter mode</b>	Off/Once/Continuous exposure mode
<b>Mono/color</b>	Mono
<b>Pixel format</b>	Mono 8/10/10p/12/12p
<b>Binning</b>	Supports 1 × 2, 1 × 4, 2 × 1, 2 × 2, 2 × 4, 4 × 1, 4 × 2, 4 × 4
<b>Decimation</b>	Supports 1 × 2, 2 × 1, 2 × 2
<b>Reverse image</b>	Supports horizontal and vertical reverse image output
<b>Image buffer</b>	128 MB
<b>Electrical features</b>	
<b>Data interface</b>	Gigabit Ethernet interface
<b>Digital I/O</b>	6-pin Hirose connector provides power and I/O, including opto-isolated input x 1 (Line 0), opto-isolated output x 1 (Line 1), and bi-directional non-isolated I/O x 1 (Line 2).
<b>Power supply</b>	12 VDC, supports PoE
<b>Power consumption</b>	Approx. 3.5 W@12 VDC
<b>Structure</b>	
<b>Lens mount</b>	C-Mount
<b>Dimension</b>	44 mm × 29 mm × 59 mm (1.7" × 1.1" × 2.3")
<b>Weight</b>	< 100 g (0.2 lb.)
<b>Ingress protection</b>	IP30 (under proper lens installation and wiring)
<b>Temperature</b>	Working temperature: 0 °C to 50 °C (32 °F to 122 °F) Storage temperature: -30 °C to 70 °C (-22 °F to 158 °F)
<b>Humidity</b>	20% to 80% RH, without condensation
<b>General</b>	
<b>Client software</b>	MVS or third-party software meeting with GigE Vision Protocol
<b>Operating system</b>	32/64-bit Windows XP/7/10, 32/64-bit Linux and 64-bit MacOS
<b>Compatibility</b>	GigE Vision V2.0, GenICam
<b>Certification</b>	CE, FCC, RoHS, KC