

CHUM-200M/C

2 MP 1/1.7" CMOS USB3.0 Area Scan Camera



GEN*i*CAM

USBTM
VISION

Introduction

CHUM-200M/C camera adopts Sony® IMX430 sensor to provide high-quality image. It uses USB3.0 interface to transmit non-compressed images in real time with max. frame rate reaching 89.1 fps in full resolution.

Key Feature

- Supports auto and manual adjustment for gain, exposure control, white balance, LUT, Gamma correction, etc.
- Supports hardware trigger, software trigger, etc.
- Supports Off, Once, Continuous exposure mode.
- Compatible with USB3 Vision Protocol, GenICam Standard, and the third-party software based on the protocol and standard.

Available Model

- Mono Camera: CHUM-200M
- Color Camera: CHUM-200C

Applicable Industry

SMT/ PCB AOI, FPD, etc.

Sensor Quantum Efficiency

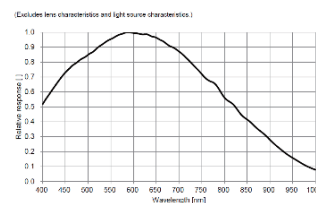

CHUM-200M

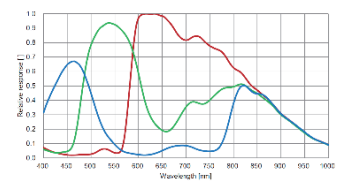

CHUM-200C

Dimension

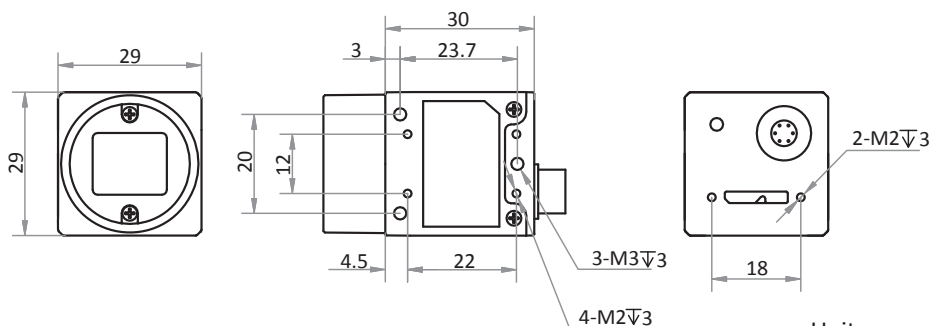

Unit: mm

Specification

Model	CHUM-200M		CHUM-200C
Camera			
Sensor type	Global shutter CMOS		
Sensor model	Sony® IMX430		
Pixel size	4.5 μm × 4.5 μm		
Sensor size	1/1.7"		
Resolution	1624 × 1240		
Max. frame rate	89.1 fps @1624 × 1240		
Dynamic range	75.4 dB		
SNR	40 dB		
Gain	0 dB to 24 dB		
Exposure time	1 μs to 10 s		
Shutter mode	Off/Once/Continuous exposure mode		
Mono/color	Mono	Color	
Pixel format	Mono 8/10/10p/12/12p	Mono 8/10/12, RGB 8, BGR 8, Bayer RG 8/10/10p/12/12p, YUV422Packed, YUV422_YUYV_Packed	
Binning	Not support		
Decimation	Supports 1 x 1, 2 x 2		
Reverse image	Supports horizontal and vertical reverse image output		
Image buffer	128 MB		
Electrical features			
Data interface	USB3.0		
Digital I/O	6-pin Hirose connector provides power and I/O, including opto-isolated input x 1 (Line 0), opto-isolated output x 1 (Line 1), bi-directional non-isolated I/O x 1 (Line 2).		
Power supply	9 VDC to 24 VDC, supports USB3.0 power supply		
Power consumption	Approx. 3.2 W@5 VDC	Approx. 3.9 W@5 VDC	
Structure			
Lens mount	C-Mount		
Dimension	29 mm × 29 mm × 30 mm (1.1" × 1.1" × 1.2")		
Weight	Approx. 80 g (0.2 lb.)		
Ingress protection	IP30 (under proper lens installation and wiring)		
Temperature	Working temperature: 0 °C to 50 °C (32 °F to 122 °F) Storage temperature: -30 °C to 70 °C (-22 °F to 158 °F)		
Humidity	20% to 80% RH, without condensation		
General			
Client software	MVS or third-party software meeting with USB3 Vision Protocol		
Operating system	32/64-bit Windows XP/7/10, 32/64-bit Linux and 64-bit MacOS		
Compatibility	USB3 Vision, GenICam		
Certification	CE, FCC, RoHS, KC		