

# Ring Illumination Low Angle Ring Illumination

SLRI  
SLRI-LA



\* With exceptions

## SLRI



High-density LED arrays in a ring shape. Provide a shadow-free uniform illumination by irradiating light toward the central portion.

### Outline Drawing

(Units: mm)

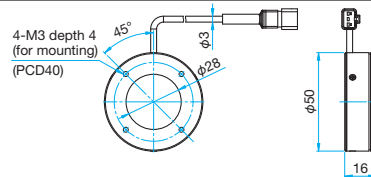

### Guide

- ▶ SLRI-42 series (outer diameter  $\phi 42$ , inner diameter  $\phi 18$ ) and SLRI-70 series (outer diameter  $\phi 70$ , inner diameter  $\phi 35$ ) are also available.
- ▶ Diffusers and polarization plates are available (Optional). Red, white, blue and green emitting colors are available.
- ▶ Diffusers, polarization plates and adapters for SLRI-42, 50 and 70 series are available. Contact our Sales Division for more information.

### Attention

- ▶ Polarization plates for SLRI-42 and 50 require mounting adapters.
- ▶ Useful power supplies: SPS-3024, SPS-3024-3-PI and SPSB-3024VB.

### Ring Illumination

Part Number	Luminescence Color	Size	Power Consumption
SLRI-50RD2	Red ●	Outer $\phi 50$ Inner $\phi 28$	24V/3.1W
SLRI-50SW2	White ○		
SLRI-50BL2	Blue ●		
SLRI-50GR2	Green ●		

### Common Specifications

Input Voltage	DC24V
Cable Length	0.3m
Input Connector	SMR-03V-B × 1 Piece
Polarity & Signal	1: Anode (+) Brown / 2: No Connection / 3: Cathode (-) Blue
Housing Material	Aluminum alloy
Cooling Method	Natural air cooling
Operating Temperature and Humidity	Temperature: 0 to 40°C, Humidity: 20 to 85%RH (No condensation)
Storage Temperature and Humidity	Temperature: -20 to 60°C, Humidity: 20 to 85%RH (No condensation)
Accessories	Instruction Guide

### Diffuser, Polarization Plate, Mounting Adapter

Part Number	Compatible Products
DF-SLRI-50	Diffuser for SLRI-50
PL-SLRI-50	Polarization plate for SLRI-50
AD-SLRI-50	Adapter for SLRI-50

## SLRI-LA

High-density LED arrays in a ring shape. Provide a shadow-free uniform illumination by irradiating light from low angles towards the central portion.



- Irradiate from low angles towards the central portion.
- Diffusers and polarization plates are available. (Optional)

### Outline Drawing

(Units: mm)

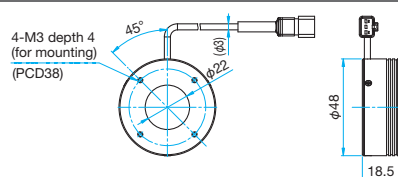

### Guide

- ▶ SLRI-74 series (outer diameter  $\phi 74$ , inner diameter  $\phi 48$ ) are available. Diffusers and polarization plates are available (Optional). Red, white, blue and green emitting colors are available.
- ▶ Diffusers for SLRI-48 or 74 series and sheet polarizers for lens mounting are available. Contact our Sales Division for more information.

### Attention

- ▶ Use SPS-3024, SPS-3024-3-PI and SPSB-3024VB as power supply.

### Low Angle Ring Illumination

Part Number	Luminescence Color	Size	Power Consumption
SLRI-48RD2-LA	Red ●	Outer $\phi 48$ Inner $\phi 22$	24V/2.1W
SLRI-48SW2-LA	White ○		
SLRI-48BL2-LA	Blue ●		
SLRI-48GR2-LA	Green ●		

### Common Specifications

Input Voltage	DC24V
Cable Length	0.3m
Input Connector	SMR-03V-B × 1 Piece
Polarity & Signal	1: Anode (+) Brown / 2: No Connection / 3: Cathode (-) Blue
Housing Material	Aluminum alloy
Cooling Method	Natural air cooling
Operating Temperature and Humidity	Temperature: 0 to 40°C, Humidity: 20 to 85%RH (No condensation)
Storage Temperature and Humidity	Temperature: -20 to 60°C, Humidity: 20 to 85%RH (No condensation)
Accessories	Instruction Guide

### Diffuser

Part Number	Compatible Products
DF-SLRI-48LA	Diffuser for SLRI-48LA