

Vacuum Base Plate | VBSP

Vacuum Base Clamps | VBSC

VBSP

NEW

RoHS



Low out-gas base plates for fixing vacuum holders and vacuum stages in the optical baseplates.

- Long cut out hole enables the smooth base plate positioning and helps fixing in the optimal position.
- Screw hole grooving and vent hole processing are applied to prevent the out-gas emits when forming vacuum.
- Besides the post holders, 25mm and 40mm stainless stages (TSDS-251, TSDS-401) can be fixed.

Guide

- ▶ We deliver the item with specialized vacuum packaging to keep its high clean state from the factory to the destination.
- ▶ We provide vacuum optical baseplates (VOBC) for fixing the post holders.

Attention

- ▶ Screws are not included. Please prepare vacuum screws (VPCB/VAGB).
- ▶ Please open the package in the clean environment. Please do not touch it by your bare hands.

Specifications		
Primary material: Steel (SUS316L) Finish: None		
Part Number	Weight [kg]	Compatible Mounting Screw Number
VBSP-2460	0.078	VPCB-6-20 or VAGB-6-20
VBSP-40100	0.260	

Outline Drawing

VBSP-2460

SUS Stainless steel washers...2 screw

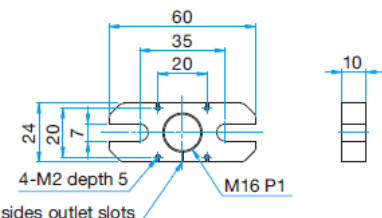

VBSP-40100

SUS Stainless steel washers...2 screw

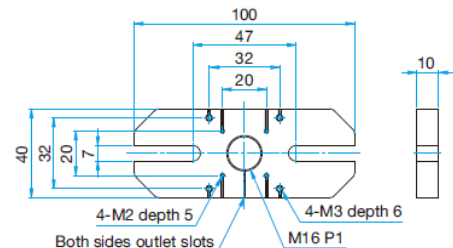

VBSC

NEW

RoHS



Low out-gas base clamps for fixing vacuum optical baseplates and vacuum base plate to the tables in the high vacuum chamber.

- Long hole and vacuum M6 screw enables fixing the 10mm thickness plates in the optimal position.
- If screws are tightened, plates are pressed firmly to the tables by leverage and the plates will be fixed.

Attention

- ▶ Screws are not included. Please prepare vacuum screws (VPCB/VAGB).
- ▶ Please open the package in the clean environment. Please do not touch it by your bare hands.

Specifications		
Primary material: Aluminum (A6061) Finish: None		
Part Number	Weight [kg]	Compatible Mounting Screw Number
VBSC-60	0.03	VPCB-6-20 or VAGB-6-20

Outline Drawing

VBSC-60

SUS Stainless steel washers...1screw

