

Post Adapter Plates | MHG-BPRO

RoHS Catalog Code W4002

These plates correct the distance offset between the center of the mirror and the mounting hole.

- When post adapter plates are used, the optical axis will move 10mm upward. (12.3mm only for MHG-12 and 7BPRO.)
- Post adapter plates can be fixed not only on posts but also on stages or baseplates using M4 screws.
- The adapters are designed for use with a mirror of 5mm thickness. Offset remains if a mirror of thickness other than 5mm is used.

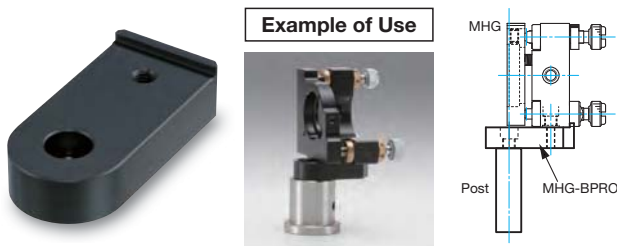

Specifications		Primary material: Aluminum Finish: Black Anodized
Part Number	Compatible Holders	Weight [kg]
MHG-12.7BPRO	MHG-MP12.7	0.02
MHG-30BPRO	MHG-MP20-NL/MHG-HS20-NL MHG-MP25/-HS25 MHG-MP30/-HS30	0.025
MHG-50BPRO	MHG-MP50/-MP50.8	0.025
MHG-100BPRO	MHG-100	0.075

Outline Drawing

MHG-12.7BPRO

- Hexagonal socket head cap screw M4x12...1 screw
- Flat washer

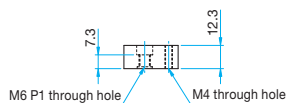
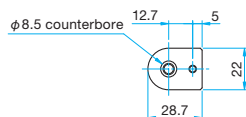

MHG-30BPRO

- Hexagonal socket head cap screw M4x10...1 screw
- Flat washer

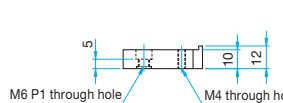
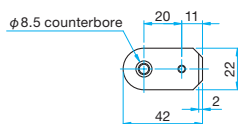

MHG-50BPRO

- Hexagonal socket head cap screw M4x10...1 screw
- Flat washer

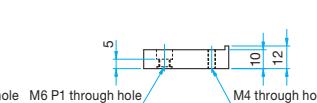
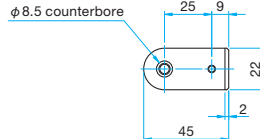

MHG-100BPRO

- Hexagonal socket head cap screw M4x10...1 screw
- Flat washer

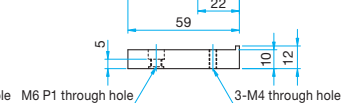
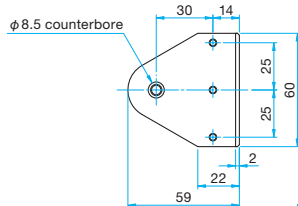

45° Optics Adapters | MHG-KAD

RoHS Catalog Code W4003

Used in a MHG kinematic mirror holder to direct a beam upwards or downwards on optical benches.

- The adjustment range and resolution of mirror holders are changed using these adapters.
- Mirrors are mounted at three points on the side.
- Since adapters are fitted in the mirror frame of the mirror holder, the orientation of the tilted surface of the mirror can be rotated about the central axis of the adapter cylinder.



Outline Drawing

MHG-KAD

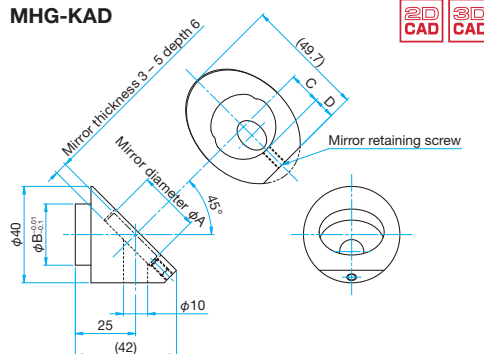

Specifications

Specifications		Primary material: Aluminum Finish: Black Anodized		
Part Number	Compatible Holders	Compatible Optics Diameter ϕA [mm]	Compatible Optics Thickness [mm]	Weight [kg]
MHG-25.4KAD	MHG-MP25.4/-HS25.4	$\phi 25.4$	3 - 5	0.07
MHG-30KAD	MHG-MP30/-HS30	$\phi 30$	3 - 5	0.07

Part Number	ϕB (mm)	C (mm)	D (mm)
MHG-25.4KAD	25.4	13.5	9
MHG-30KAD	30	15.5	7

Mirror Mount Adapters | MHG-MAD

RoHS Catalog Code W4004

Adapters for mounting smaller diameter mirrors.



- Adapters are designed so that the end faces of mirror frames are aligned with the end faces of adapters when adapters are attached to kinematic mirror holders (MHG). However, the reflective surface of a mirror is positioned 1mm inside the end face of adapter.
- Mirrors are fixed at three points on the lateral side.
- Before mounting adapters to mirror holders, fix mirrors to the adapters. Mirrors cannot be mounted once the adapter is mounted in a mirror holder.
- The reflective surface position is dependant on the mirror thickness.

Example of Use



Specifications				Primary material: Aluminum Finish: Black Anodized
Part Number	Compatible Holders	Compatible Optics Diameter [mm]	Compatible Optics Thickness [mm]	Weight [kg]
MHG-40MAD	MHG-MP50	φ40	4 – 6	0.015
MHG-60MAD	MHG-80	φ60	6 – 10	0.06
MHG-25.4SMAD	MHG-MP25/-HS25	□25, □25.4	3 – 5	0.018

Outline Drawing

MHG-40MAD

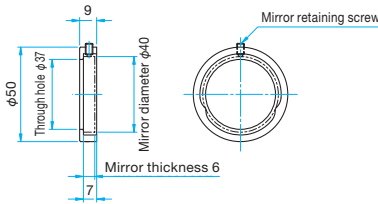

MHG-60MAD

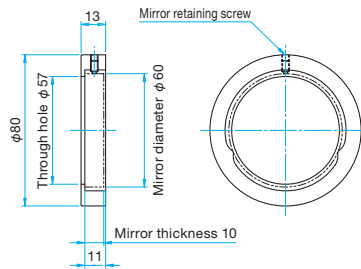

MHG-25.4SMAD

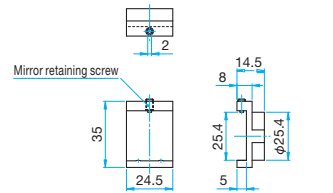

Prism Adapters | MHG-PAD

RoHS Catalog Code W4007

Adapters for holding cube optics such as beamsplitters or prisms. Provide extended stability with NOMI LOCK™.

- Rotation (θ or yaw) and tilt (α or pitch) of prisms and cube optics can be fine adjusted with this adapter. To adjust yaw tilt (β), fit the prism adapters in kinematic mirror holders after adjusting the orientation.
- There is a through hole on the moun so that prisms can be used on all four faces.
- There is an offset of 40mm from the baseplate mounting hole of the kinematic mirror holder to the center of cube.
- The clamp allows for different sized cubes to be mounted.



Example of Use



Outline Drawing

MHG-12.7PAD

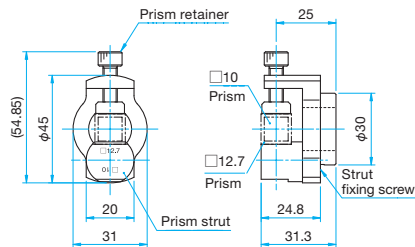

MHG-20PAD

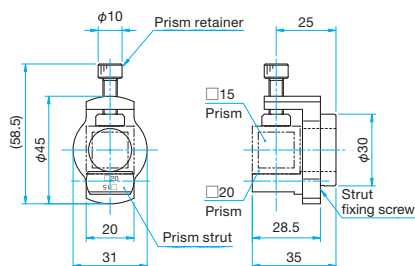

Specifications

Primary material: Aluminum
Finish: Black Anodized

Part Number	Compatible Holders	Compatible Optics Diameter [mm]	Weight [kg]
MHG-12.7PAD	MHG-MP30/-HS30	□10-□12.7	0.06
MHG-20PAD	MHG-MP30/-HS30	□15-□20	0.055

Optical Path Flip Mounts | FMB

RoHS Catalog Code W4006

Flip mounts remove and insert mirrors/lenses from an optical paths.



- A 3 mm thick mirror and MHG-MP20-NL can be used to for a mirror at the center with 45 degrees incident light. FMB-25 can be used in combination with a mirror mount (MHI or BSHL).
- These flip mounts have 5" repeatability. NOMI LOCK™ mounts used with these flip mounts will have excellent repeatability
- To mount the high precision mirror holder (MHG-HS**-NL), use the accessory spacer for adjusting height in order to avoid interference with adjustment screws.

Outline Drawing

FMB-25 Hexagonal socket head cap screw M4x12...1 screw

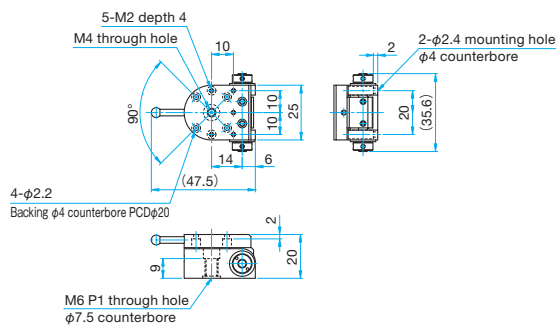

FMB-40 Hexagonal socket head cap screw M4x12...1 screw
Countersunk head screw M4x8...2 screws

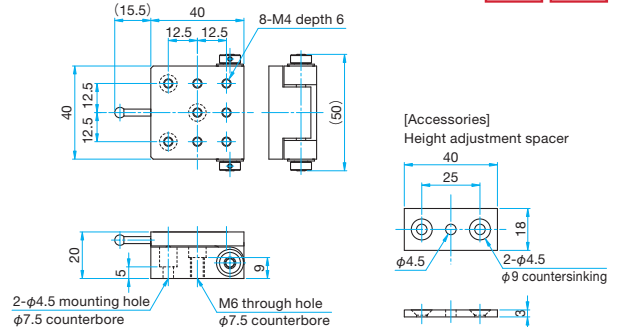

Specifications		Primary material: Aluminum Finish: Black Anodized
Part Number	Repeatability ["]	Weight [kg]
FMB-25	5 (25μrad)	0.04
FMB-40	5 (25μrad)	0.1

* For specifying options, please refer to "Conversion of Posts, Post Holders and Pedestal Bases of Holders". [Reference](#) C007

Example of Use



Laser Mounts | MHG-20LDU

RoHS Catalog Code W4005

Adapter for mounting laser diodes (LDU33) or other φ20 mm laser diodes with kinematic mirror holders.



- Split clamp structure of the laser mounts fix laser diodes securely. Caution: excessive clamping might damage laser diodes.
- Mounts can be used as fixed LD holders when a post is attached to the bottom of the mounts.
- Laser diodes (LDU33) are sold separately. Refer to the light sources section for details of the specifications. [WEB Reference](#) [Catalog Code](#) W5001

Outline Drawing

MHG-20LDU

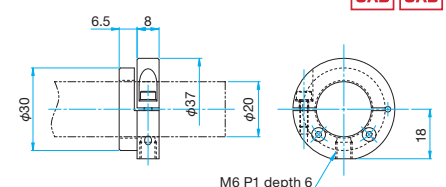

Specifications			Primary material: Aluminum Finish: Black Anodized	
Part Number	Compatible Holders	Compatible Laser	Compatible Diameter [mm]	Weight [kg]
MHG-20LDU	MHG-HS30/-MP30	LDU33 series	φ20	0.02