

Pulse Generating Controller | PGC-04-U

RoHS

CE

4-axis pulse generator type controller that can be connected to the various motor drivers.

- External control with USB and Ethernet interfaces are available.
- Can be manually operated by a Handy Terminal (JS-300, JB-400, JD-100).



Guide

- ▶ Sample programs are available for download from our website.
 - SG Sample 32/64-bit version for Windows® (only for RS232C)
 - Lab VIEW for RS232C (for v.2014/v.2015)

Attention

- ▶ Cable and motor driver are sold separately. Please purchase 5-phase stepping motor drivers MC-S0514ZU or prepare compatible driver of customer choice.
- ▶ Power supply is DC+24V 2A. You need to purchase the PAT-001-POW1 (AC adapter) or prepare an adapter separately.

Products Name	Part Number
Pulse Generating Controller	PGC-04-U
Joystick Terminal	JS-300
Jog Operation Box	JB-400
Jog Dial	JD-100
AC Adapter	PAT-001-POW1

Primary Functions

Controller Function	○
Number of Control Axes	4
Stored Program Control	○
Feedback Control	—
Circular Interpolation Control	○
Linear Interpolation Control	3 axes
Driver Function	—
Micro-step (Max. Division)	—
Driving Current (A/phase)	—

General Specifications

Power Voltage	DC24V
Power Consumption	1.4A
Operating Temperature	5 – 40°C
Storage Temperature	–20 – 60°C
Ambient Humidity	20 – 80%RH (without condensation)
External Dimensions (W×H×Dmm)	180×140×60
Weight (kg)	1.3

Interface

GP-IB	—
RS232C	—
USB	○
Ethernet	○

Optional

CJ-200A	—
JS-300	○
JB-400	○
JD-100	○
SJT-02	—

Performance Specifications

Coordinate Indication Range	—
Max. Travel to Set	134,217,727
Max. Driving Speed (pps)	4,000,000
Min. Driving Speed (pps)	1
Acceleration/Deceleration Time (ms)	1 – 1,000

I/O Specification

Origin Sensor	○
Proximity Sensor	○
CW (+) Limit	○
CCW (–) Limit	○
General Purpose Input	4 points
General Purpose Output	4 points
Control Input	—
Control Output	—
Trigger Output	—

Control Command

Machine Origin Return	○
Theoretical Origin Setting	○
Relative Position Drive	○
Absolute Position Drive	○
Jog Operation	○
Position Appointment	—
Circular Interpolation Control	○
Linear Interpolation Control	○
Drive	—
Deceleration Stop	○
Emergency Stop	○
Speed Setting	○
Motor Free/Hold	○
Port Input	○
Port Output	○

Application Systems

Optics & Optical Coatings

Opto-Mechanics

Bases

Manual Stages

Actuators & Adjusters

Motorized Stages

Light Sources & Laser Safety

Index

Guide

Controllers/Drivers

Softwares

Stepping Motor

AC Servo Motor

Cables

Piezo

X Translation

Theta Rotation

Goniometer

Vacuum

Options

40 × 40 mm

60 × 60 mm

80 × 80 mm

85 × 85 mm

100 × 100 mm

120 × 120 mm

Others

System Diagram

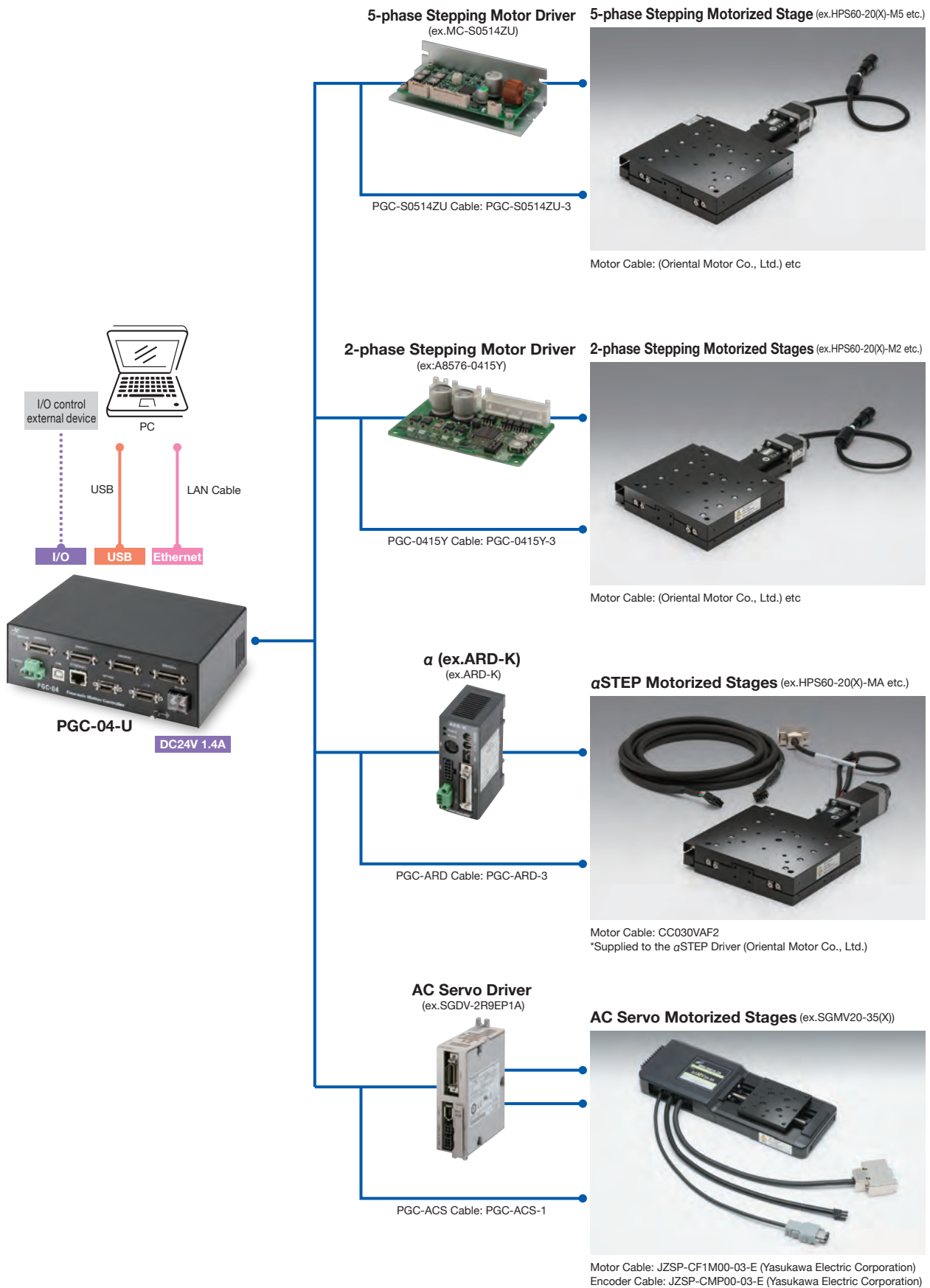

Application Systems

Optics & Optical Coatings

Opto-Mechanics

Bases

Manual Stages

Actuators & Adjusters

MotORIZED Stages

Light Sources & Laser Safety

Index

Guide

Controllers/Drivers

Softwares

Stepping Motor

AC Servo Motor

Cables

Piezo

X Translation

Theta Rotation

Goniometer

Vacuum

Options

40 × 40 mm

60 × 60 mm

80 × 80 mm

85 × 85 mm

100 × 100 mm

120 × 120 mm

Others