

## Z axis Preset Stages | MLT23 Stage size □15/□25/□40/□60mm



Application Systems

Machine Vision

Manual Positions

Motion Control Products

Optical & Mirror Holder

FA Parts

Measurement & Control

FA Electrical Parts

Tool & Measure

Cleanroom & AntiStatic

Index

X Axis

XY Axis

Z Axis

XZ Axis

XYZ Axis

Rotation

Goniometers /Tilt

Multiaxis

Linear Guide

□15mm

□25mm

□40mm

□50mm

□60mm

□70mm

□80mm

□100mm

□120mm

Others

**Space-saving, no compact Z axis stages with horizontal table top, suitable for less frequent operations that require fine adjustment.**

- Ideal for less frequent operations and fine adjustment.
- Elimination of adjustment knobs can prevent errant operations, and elimination of protrusions makes these stages suitable for assembly in systems.



### Mounting Method

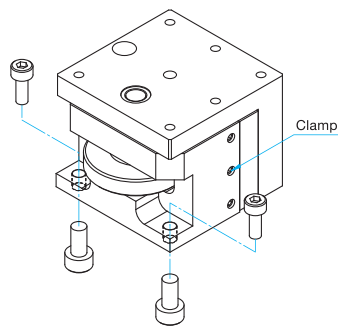

### Guide

▶ A hex wrench with knob and clamping wrench are included.

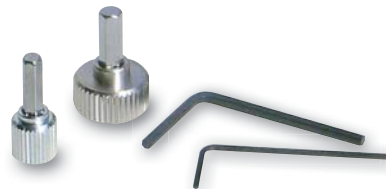

### Detailed Illustration

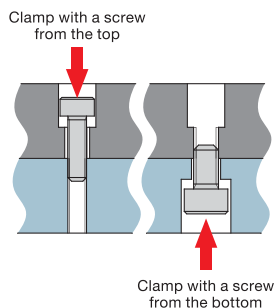

#### Top mounting

Tapped holes are used as counterbores because screws are smaller than tapped holes and will go in without any interference.

#### Bottom mounting

Clamp with screws that match the specification of tapped holes.

### About Mounting Holes

The bottom mounting holes of preset stages are tapped holes. These stages allow mounting from the top or the bottom, convenient for securing on optical breadboards or other instruments as well as assembling in systems.

Use the screws of the sizes listed in the table on the right for mounting.

Part Number	Secure from the top	Secure from the bottom
MLT23-15	M2	M2.6
MLT23-25	M2	M3
MLT23-40	M3	M4
MLT23-60	M4	M5

### Specifications

Part Number	MLT23-15	MLT23-25	MLT23-40	MLT23-60
Table Size [mm]	15×15	25×25	40×40	60×60
Travel [mm]	+2 / -0	+3 / -0	+5 / -0	+7 / -0
Screw Pitch [mm]	0.4	0.5	0.5	0.5
Positioning Slide	Dovetail slide method	Dovetail slide method	Dovetail slide method	Dovetail slide method
Primary Material	Brass	Brass	Brass	Brass
Finish	Super black chrome	Super black chrome	Super black chrome	Super black chrome
Load Capacity [N]	4.9 (0.5kgf)	6.9 (0.7kgf)	29.4 (3.0kgf)	98.1 (10.0kgf)
Travel Accuracy	Straightness [μm]	30	30	30
Max. Moment Capacity	Pitch [N·m]	—	0.3	0.5
	Roll [N·m]	—	0.3	0.5
Moment Stiffness	Pitch [°/N·cm]	—	6.1	4.59
	Roll [°/N·cm]	—	4.1	2.55
Parallelism [μm]	100	100	100	100
Weight [kg]	0.012	0.05	0.2	0.9



**Outline Drawing**

**MLT23-15**

- ☒ Pan head screw M2×5...4 screws, One 0.89mm hex wrench
- ☒ Adjustment hole size  $\phi 1.8\text{mm}$ , Wrench size for clamp 0.89mm

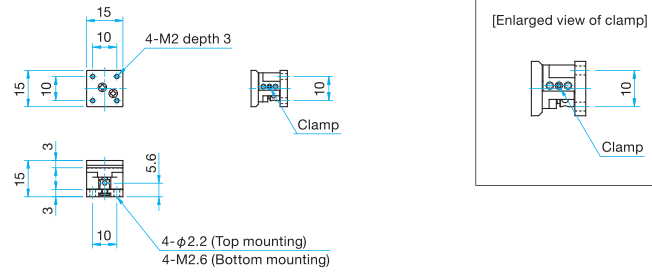

**MLT23-25**

- ☒ Hexagonal socket head cap screw M2×6...3 screws, One 0.89mm hex wrench
- ☒ Wrench size for clamp 0.89mm

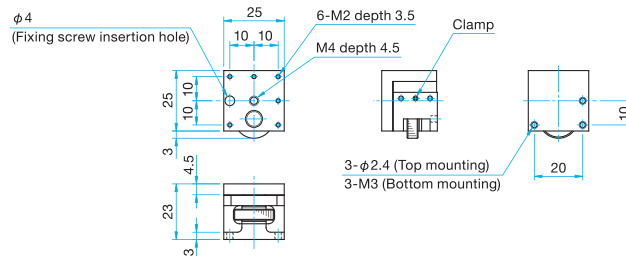

**MLT23-40**

- ☒ Hexagon socket head cap screw M3×8...3 screws, One 1.5mm hex wrench
- ☒ Wrench size for clamp 1.5mm

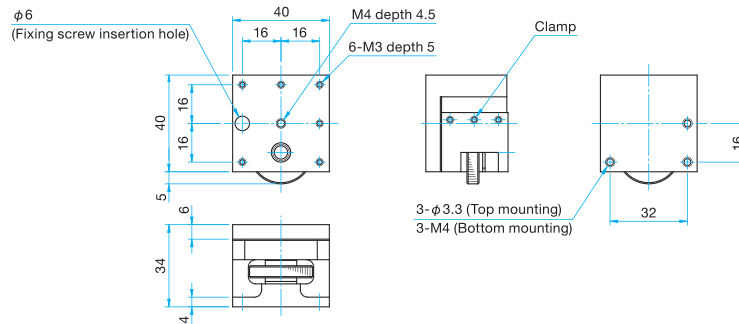

**MLT23-60**

- ☒ Hexagonal socket head cap screw M4×10...3 screws, One 1.5mm hex wrench
- ☒ Adjustment hole size  $\phi 3\text{mm}$ , Wrench size for clamp 1.5mm

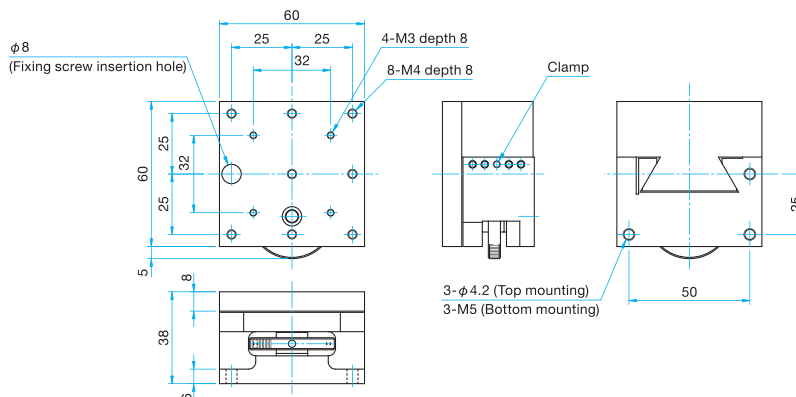

Application Systems

Machine Vision

Manual Positions

Motion Control Products

Optical & Mirror Holder

F A Parts

Measurement & Control

FA Electrical Parts

Tool & Measure

Cleanroom & AntiStatic

Index

X Axis

XY Axis

Z Axis

XZ Axis

XYZ Axis

Rotation

Goniometers /Tilt

Multiaxis

Linear Guide

☐15mm

☐25mm

☐40mm

☐50mm

☐60mm

☐70mm

☐80mm

☐100mm

☐120mm

Others